







- ①  Substrate
- ②  Existing Waterproofing
- ③  Concrete/Timber/Asphalt/Felt Substrate: **Proteus Pro-Vapour Control/Carrier Membrane SA** adhered with **Proteus Pro-Prime® SA**
- ③  PVC Substrate: **Proteus Pro-Vapour Control/Carrier Membrane SA** adhered with **Proteus Pro-Prime® PVC**
- ③  Metal Substrate: **Proteus Pro-Vapour Control/Carrier Membrane SA** adhered with **Proteus Pro-Prime® Epoxy**
- ④  **Proteus Pro-Cold®** base coat with embedded **Proteus Pro-Force 225** reinforcement
- ⑤  **Proteus Pro-Cold®** top coat



Proteus Waterproofing Ltd.

21a Sirdar Road,
Brook Road Industrial Estate,
Rayleigh, Essex, SS6 7XF

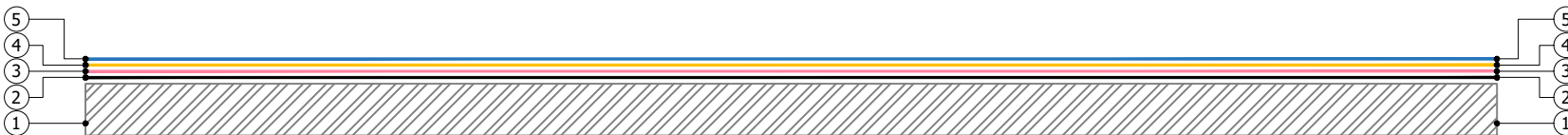
Tel: +44 (0)1268 777871

W: www.proteuswaterproofing.co.uk

E: office@proteuswaterproofing.co.uk

All components are to be prepared and installed in strict accordance with Proteus Project Specification

Notes :

This drawing is solely intended to illustrate the correct application of Proteus Waterproofing Ltd's products and systems. All other elements bearing reference to structural and/or thermal design within the detail are shown indicatively and should not be used in whole or part for any aspect of project design without consulting the relevant authorities.

For refurbishment projects, all aspects of the existing roof are deemed to be fully compliant with BS 6229 (Code of practice for flat roofs with continuously supported coverings) or improved upon for instances where these standards are not met.

© This drawing is the copyright of Proteus Waterproofing Ltd.







Drawing No.:	Roof Type:
SD_PC_OVERLAY_01	Overlay

Description:
Horizontal Surface

Scale:	Drawn:	Date:
NTS	W.Harding	18/07/2024

Proteus Pro-Cold®



- ①  Substrate
- ②  Existing Waterproofing
- ③  Concrete/Timber/Asphalt/Felt Substrate: **Proteus Pro-Vapour Control/Carrier Membrane SA** adhered with **Proteus Pro-Prime® SA**
- ③  PVC Substrate: **Proteus Pro-Vapour Control/Carrier Membrane SA** adhered with **Proteus Pro-Prime® PVC**
- ③  Metal Substrate: **Proteus Pro-Vapour Control/Carrier Membrane SA** adhered with **Proteus Pro-Prime® Epoxy**
- ④  **Proteus Pro-Cold®** base coat with embedded **Proteus Pro-Force 225** reinforcement
- ⑤  **Proteus Pro-Cold®** top coat

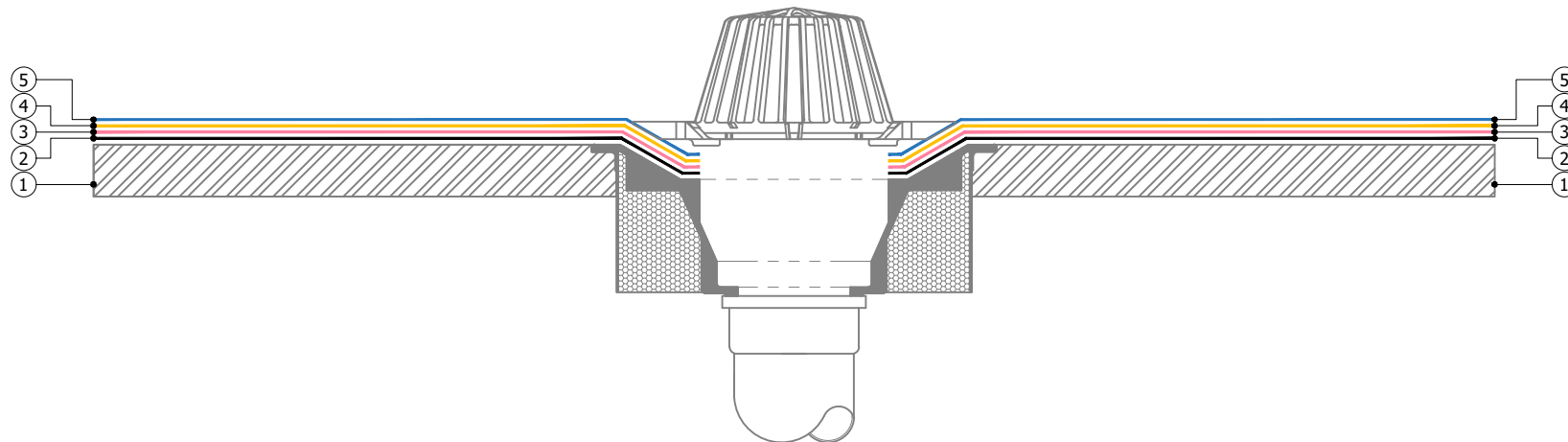

Proteus Waterproofing Ltd.

21a Sirdar Road,
Brook Road Industrial Estate,
Rayleigh, Essex, SS6 7XF

Tel: +44 (0)1268 777871

W: www.proteuswaterproofing.co.uk

E: office@proteuswaterproofing.co.uk

All components are to be prepared and installed in strict accordance with **Proteus Project Specification**

Notes :









This drawing is solely intended to illustrate the correct application of Proteus Waterproofing Ltd's products and systems. All other elements bearing reference to structural and/or thermal design within the detail are shown indicatively and should not be used in whole or part for any aspect of project design without consulting the relevant authorities.

For refurbishment projects, all aspects of the existing roof are deemed to be fully compliant with BS 6229 (Code of practice for flat roofs with continuously supported coverings) or improved upon for instances where these standards are not met.

© This drawing is the copyright of Proteus Waterproofing Ltd.

Drawing No.:		Roof Type:
SD_PC_OVERLAY_02		Overlay
Description:		
Vertical Rainwater Outlet		
Scale:	Drawn:	Date:
NTS	W.Harding	18/07/2024



- ①  Substrate
- ②  Rooflight/ Roof Access Hatch
- ③  Existing Waterproofing
- ④  Concrete/Timber/Asphalt/Felt Substrate: **Proteus Pro-Vapour Control/Carrier Membrane SA** adhered with **Proteus Pro-Prime® SA**
- ④  PVC Substrate: **Proteus Pro-Vapour Control/Carrier Membrane SA** adhered with **Proteus Pro-Prime® PVC**
- ④  Metal Substrate: **Proteus Pro-Vapour Control/Carrier Membrane SA** adhered with **Proteus Pro-Prime® Epoxy**
- ⑤  **Proteus Pro-Cold®** base coat with embedded **Proteus Pro-Force 225** reinforcement
- ⑥  **Proteus Pro-Cold®** top coat
- ⑦  **Proteus Sealant**

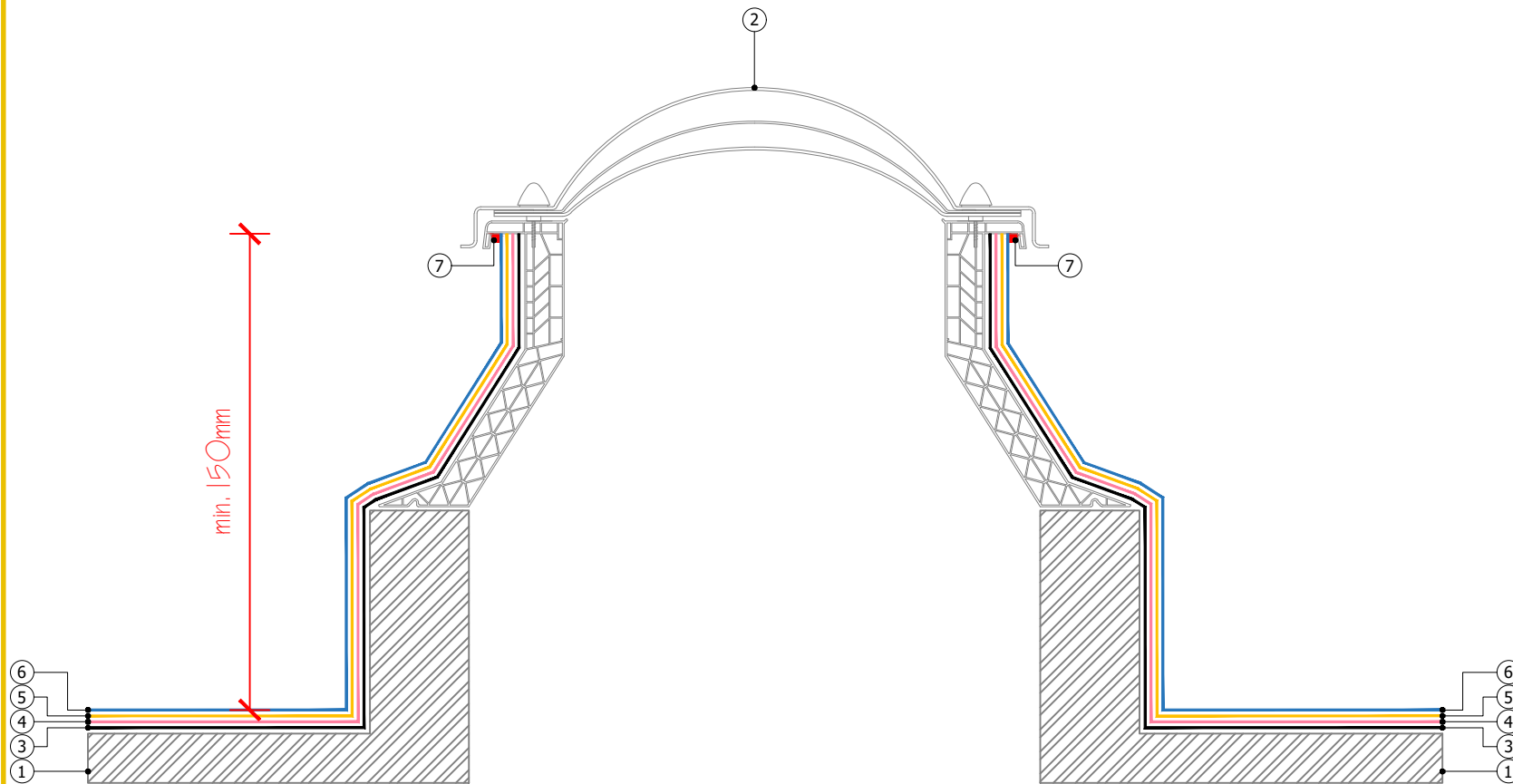

Proteus Waterproofing Ltd.

21a Sirdar Road,
 Brook Road Industrial Estate,
 Rayleigh, Essex, SS6 7XF

Tel: +44 (0)1268 777871

W: www.proteuswaterproofing.co.uk

E: office@proteuswaterproofing.co.uk

All components are to be prepared and installed in strict accordance with Proteus Project Specification

Notes :

This drawing is solely intended to illustrate the correct application of Proteus Waterproofing Ltd's products and systems. All other elements bearing reference to structural and/or thermal design within the detail are shown indicatively and should not be used in whole or part for any aspect of project design without consulting the relevant authorities.

For refurbishment projects, all aspects of the existing roof are deemed to be fully compliant with BS 6229 (Code of practice for flat roofs with continuously supported coverings) or improved upon for instances where these standards are not met.

© This drawing is the copyright of Proteus Waterproofing Ltd.

Drawing No.:	Roof Type:
SD_PC_OVERLAY_03	Overlay

Description:
Rooflight / Access Hatch

Scale:	Drawn:	Date:
NTS	W.Harding	18/07/2024

Proteus Pro-Cold®



- ① Substrate
- ② Existing Waterproofing
- ③ Concrete/Timber/Asphalt/Felt Substrate: **Proteus Pro-Vapour Control/Carrier Membrane SA** adhered with **Proteus Pro-Prime® SA**
- ③ PVC Substrate: **Proteus Pro-Vapour Control/Carrier Membrane SA** adhered with **Proteus Pro-Prime® PVC**
- ③ Metal Substrate: **Proteus Pro-Vapour Control/Carrier Membrane SA** adhered with **Proteus Pro-Prime® Epoxy**
- ④ **Proteus Pro-Cold®** base coat with embedded **Proteus Pro-Force 225** reinforcement
- ⑤ **Proteus Pro-Cold®** top coat
- ⑥ **Proteus Sealant**

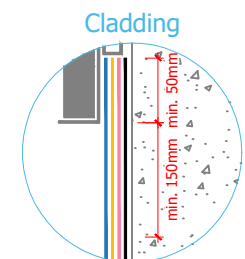

A New vertical cladding installed to provide minimum 50mm weathering lap

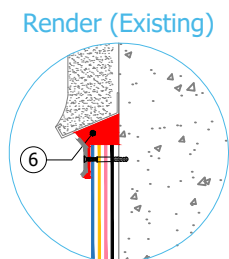

B Seal with a continuous minimum 6mm bead of **Proteus Sealant** following through cure of the System

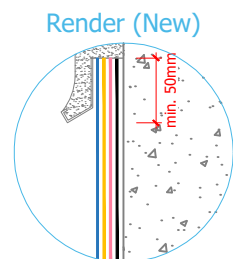

C Traditional render application with mechanically fixed bell cast/stop bead installed to overlap Waterproofing membrane by minimum 50mm

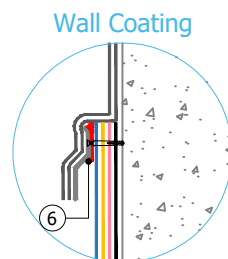

D Mechanically fixed **Proteus Counter Flashing** used as the lower termination position of the specified wall coating

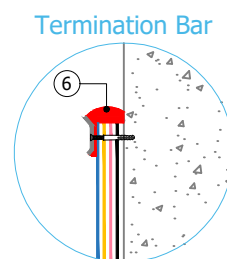

E Waterproofing System terminated with a mechanically fixed **Proteus Termination Bar**, sealed and bedded with **Proteus Sealant**

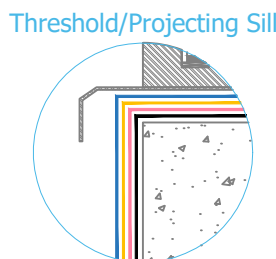

F Waterproofing System terminated tightly at the junction with the projecting sill and sealed with **Proteus Sealant**

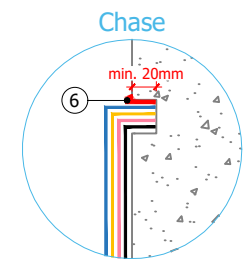

G Waterproofing System terminated in a 25mm x 10mm cleaned and primed pre-cut chase sealed with **Proteus Sealant**

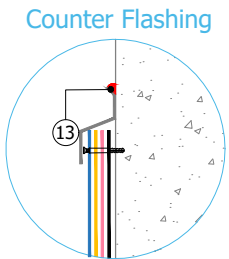

H Waterproofing System terminated with a mechanically fixed **Proteus Counter Flashing**, sealed and bedded with **Proteus Sealant**

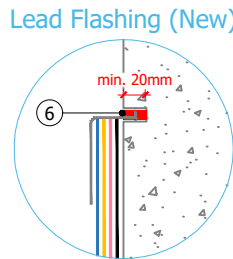

I New Lead Flashings installed in strict accordance with BS 6915 and LSA guidelines

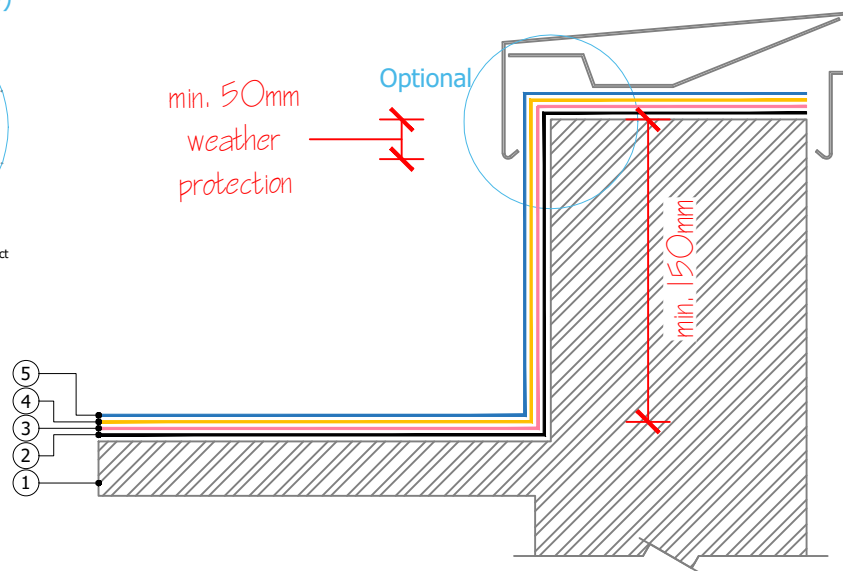

Proteus Waterproofing Ltd.
 21a Sirdar Road,
 Brook Road Industrial Estate,
 Rayleigh, Essex, SS6 7XF
 Tel: +44 (0)1268 777871
 W: www.proteuswaterproofing.co.uk
 E: office@proteuswaterproofing.co.uk

All components are to be prepared and installed in strict accordance with **Proteus Project Specification**

Notes :
 This drawing is solely intended to illustrate the correct application of Proteus Waterproofing Ltd's products and systems. All other elements bearing reference to structural and/or thermal design within the detail are shown indicatively and should not be used in whole or part for any aspect of project design without consulting the relevant authorities.







For refurbishment projects, all aspects of the existing roof are deemed to be fully compliant with BS 6229 (Code of practice for flat roofs with continuously supported coverings) or improved upon for instances where these standards are not met.
 © This drawing is the copyright of Proteus Waterproofing Ltd.

Drawing No.: SD_PC_OVERLAY_04		Roof Type: Overlay
Description: Upstand Terminations		
Scale: NTS	Drawn: W.Harding	Date: 17/09/2024

Proteus Pro-Cold®

Proteus

WATERPROOFING

- ①  Substrate
- ②  Existing Waterproofing
- ③  Concrete/Timber/Asphalt/Felt Substrate: **Proteus Pro-Vapour Control/Carrier Membrane SA** adhered with **Proteus Pro-Prime® SA**
- ③  PVC Substrate: **Proteus Pro-Vapour Control/Carrier Membrane SA** adhered with **Proteus Pro-Prime® PVC**
- ③  Metal Substrate: **Proteus Pro-Vapour Control/Carrier Membrane SA** adhered with **Proteus Pro-Prime® Epoxy**
- ④  **Proteus Pro-Cold®** base coat with embedded **Proteus Pro-Force 225** reinforcement
- ⑤  **Proteus Pro-Cold®** top coat

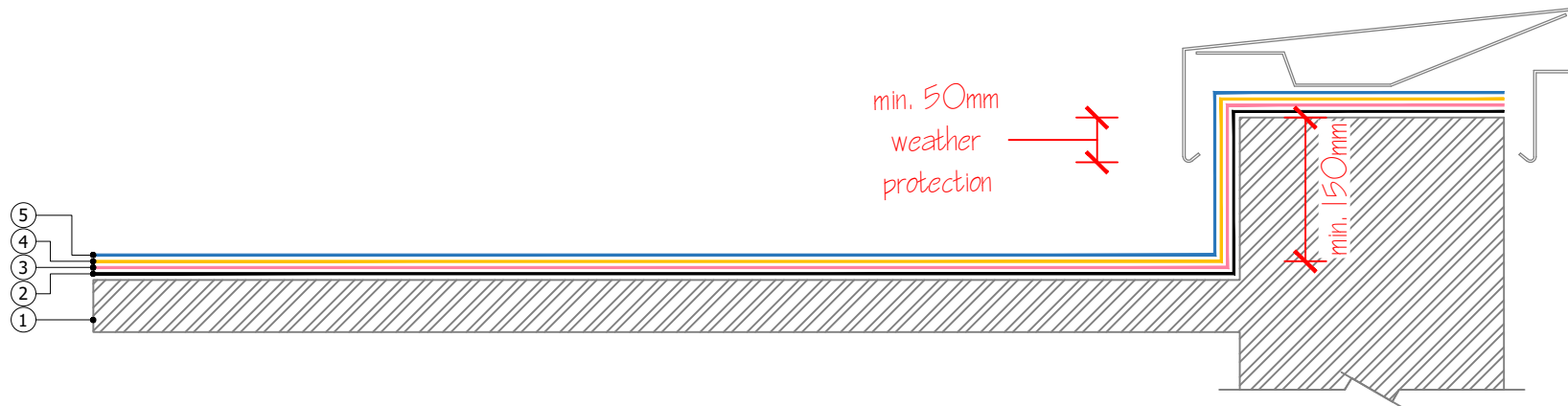

Proteus Waterproofing Ltd.

21a Sirdar Road,
Brook Road Industrial Estate,
Rayleigh, Essex, SS6 7XF

Tel: +44 (0)1268 777871

W: www.proteuswaterproofing.co.uk

E: office@proteuswaterproofing.co.uk

All components are to be prepared and installed in strict accordance with Proteus Project Specification

Notes :









This drawing is solely intended to illustrate the correct application of Proteus Waterproofing Ltd's products and systems. All other elements bearing reference to structural and/or thermal design within the detail are shown indicatively and should not be used in whole or part for any aspect of project design without consulting the relevant authorities.

For refurbishment projects, all aspects of the existing roof are deemed to be fully compliant with BS 6229 (Code of practice for flat roofs with continuously supported coverings) or improved upon for instances where these standards are not met.

© This drawing is the copyright of Proteus Waterproofing Ltd.

Drawing No.:		Roof Type:
SD_PC_OVERLAY_06		Overlay
Description:		
Parapet - Capping		
Scale:	Drawn:	Date:
NTS	W.Harding	18/07/2024



- ①  Substrate
- ②  **GRP Trim** (mechanically fixed) and **Proteus Sealant**
- ③  Existing Waterproofing
- ④  Concrete/Timber/Asphalt/Felt Substrate: **Proteus Pro-Vapour Control/Carrier Membrane SA** adhered with **Proteus Pro-Prime® SA**
- ④  PVC Substrate: **Proteus Pro-Vapour Control/Carrier Membrane SA** adhered with **Proteus Pro-Prime® PVC**
- ④  Metal Substrate: **Proteus Pro-Vapour Control/Carrier Membrane SA** adhered with **Proteus Pro-Prime® Epoxy**
- ⑤  **Proteus Pro-Cold®** base coat with embedded **Proteus Pro-Force 225** reinforcement
- ⑥  **Proteus Pro-Cold®** top coat

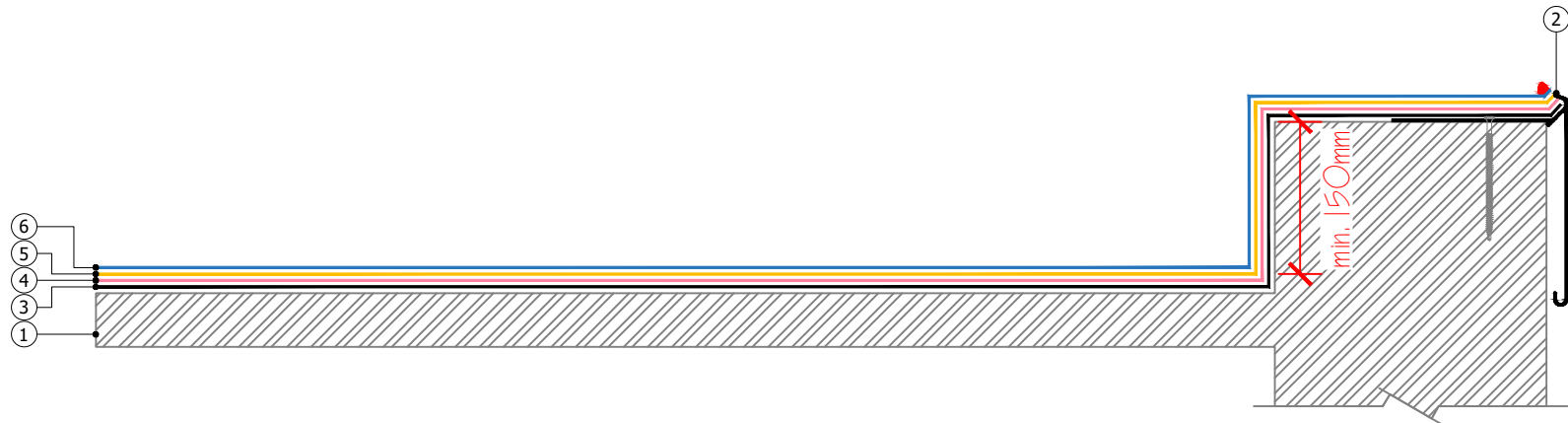

Proteus Waterproofing Ltd.

21a Sirdar Road,
Brook Road Industrial Estate,
Rayleigh, Essex, SS6 7XF

Tel: +44 (0)1268 777871

W: www.proteuswaterproofing.co.uk

E: office@proteuswaterproofing.co.uk

All components are to be prepared and installed in strict accordance with Proteus Project Specification

Notes :

This drawing is solely intended to illustrate the correct application of Proteus Waterproofing Ltd's products and systems. All other elements bearing reference to structural and/or thermal design within the detail are shown indicatively and should not be used in whole or part for any aspect of project design without consulting the relevant authorities.

For refurbishment projects, all aspects of the existing roof are deemed to be fully compliant with BS 6229 (Code of practice for flat roofs with continuously supported coverings) or improved upon for instances where these standards are not met.

© This drawing is the copyright of Proteus Waterproofing Ltd.









Drawing No.:	Roof Type:
SD_PC_OVERLAY_07	Overlay

Description:
Parapet - GRP Trim

Scale:	Drawn:	Date:
NTS	W.Harding	18/07/2024

Proteus Pro-Cold®



- ①  Substrate
- ②  Existing Waterproofing
- ③  Concrete/Timber/Asphalt/Felt Substrate: **Proteus Pro-Vapour Control/Carrier Membrane SA** adhered with **Proteus Pro-Prime® SA**
- ③  PVC Substrate: **Proteus Pro-Vapour Control/Carrier Membrane SA** adhered with **Proteus Pro-Prime® PVC**
- ③  Metal Substrate: **Proteus Pro-Vapour Control/Carrier Membrane SA** adhered with **Proteus Pro-Prime® Epoxy**
- ④  **Proteus Pro-Cold®** base coat with embedded **Proteus Pro-Force 225** reinforcement
- ⑤  **Proteus Pro-Cold®** top coat
- ⑥  **Proteus Sealant**

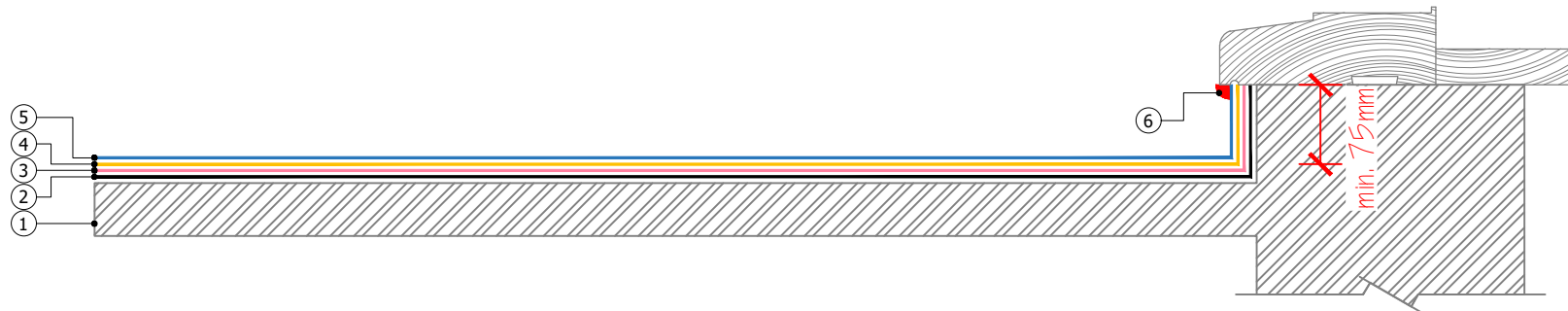

Proteus Waterproofing Ltd.

21a Sirdar Road,
Brook Road Industrial Estate,
Rayleigh, Essex, SS6 7XF

Tel: +44 (0)1268 777871

W: www.proteuswaterproofing.co.uk

E: office@proteuswaterproofing.co.uk

All components are to be prepared and installed in strict accordance with **Proteus Project Specification**

Notes :

This drawing is solely intended to illustrate the correct application of Proteus Waterproofing Ltd's products and systems. All other elements bearing reference to structural and/or thermal design within the detail are shown indicatively and should not be used in whole or part for any aspect of project design without consulting the relevant authorities.

For refurbishment projects, all aspects of the existing roof are deemed to be fully compliant with BS 6229 (Code of practice for flat roofs with continuously supported coverings) or improved upon for instances where these standards are not met.









© This drawing is the copyright of Proteus Waterproofing Ltd.

Drawing No.:	Roof Type:
SD_PC_OVERLAY_08	Overlay

Description:
Threshold (Existing) - Sealant

Scale:	Drawn:	Date:
NTS	W.Harding	18/07/2024



- ①  Substrate
- ②  Existing Waterproofing
- ③  Concrete/Timber/Asphalt/Felt Substrate: **Proteus Pro-Vapour Control/Carrier Membrane SA** adhered with **Proteus Pro-Prime® SA**
- ③  PVC Substrate: **Proteus Pro-Vapour Control/Carrier Membrane SA** adhered with **Proteus Pro-Prime® PVC**
- ③  Metal Substrate: **Proteus Pro-Vapour Control/Carrier Membrane SA** adhered with **Proteus Pro-Prime® Epoxy**
- ④  **Proteus Pro-Cold®** base coat with embedded **Proteus Pro-Force 225** reinforcement
- ⑤  **Proteus Pro-Cold®** top coat
- ⑥  EPDM membrane (min. 100mm lap onto waterproofing)

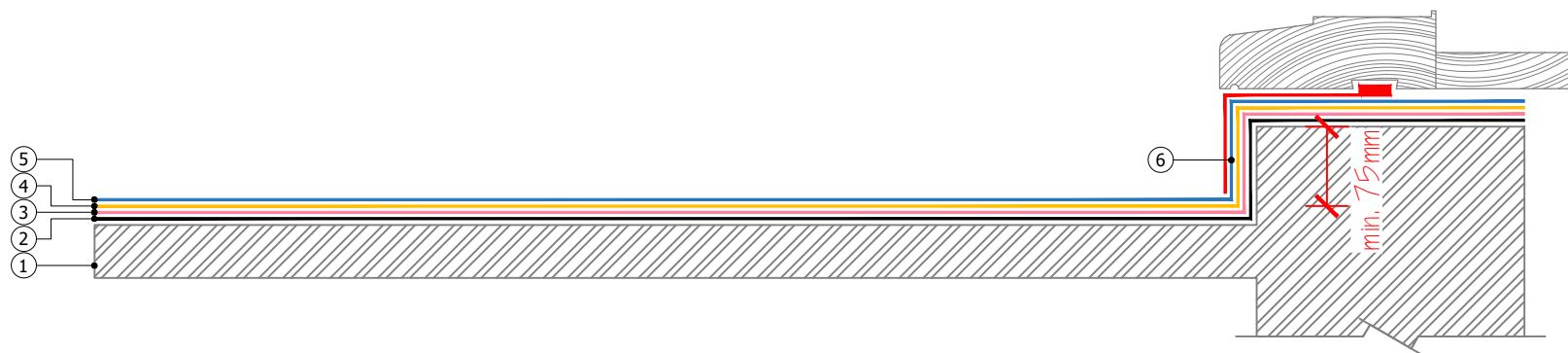

Proteus Waterproofing Ltd.
 21a Sirdar Road,
 Brook Road Industrial Estate,
 Rayleigh, Essex, SS6 7XF
 Tel: +44 (0)1268 777871
 W: www.proteuswaterproofing.co.uk
 E: office@proteuswaterproofing.co.uk

All components are to be prepared and installed in strict accordance with Proteus Project Specification

Notes :









This drawing is solely intended to illustrate the correct application of Proteus Waterproofing Ltd's products and systems. All other elements bearing reference to structural and/or thermal design within the detail are shown indicatively and should not be used in whole or part for any aspect of project design without consulting the relevant authorities.

For refurbishment projects, all aspects of the existing roof are deemed to be fully compliant with BS 6229 (Code of practice for flat roofs with continuously supported coverings) or improved upon for instances where these standards are not met.

© This drawing is the copyright of Proteus Waterproofing Ltd.

Drawing No.:		Roof Type:
SD_PC_OVERLAY_09		Overlay
Description:		
Threshold (New) - EPDM		
Scale:	Drawn:	Date:
NTS	W.Harding	18/07/2024



- ①  Substrate
- ②  Existing Waterproofing
- ③  Concrete/Timber/Asphalt/Felt Substrate: **Proteus Pro-Vapour Control/Carrier Membrane SA** adhered with **Proteus Pro-Prime® SA**
- ③  PVC Substrate: **Proteus Pro-Vapour Control/Carrier Membrane SA** adhered with **Proteus Pro-Prime® PVC**
- ③  Metal Substrate: **Proteus Pro-Vapour Control/Carrier Membrane SA** adhered with **Proteus Pro-Prime® Epoxy**
- ④  **Proteus Pro-Cold®** base coat with embedded **Proteus Pro-Force 225** reinforcement
- ⑤  **Proteus Pro-Cold®** top coat
- ⑥  Jubilee Clip (by others)

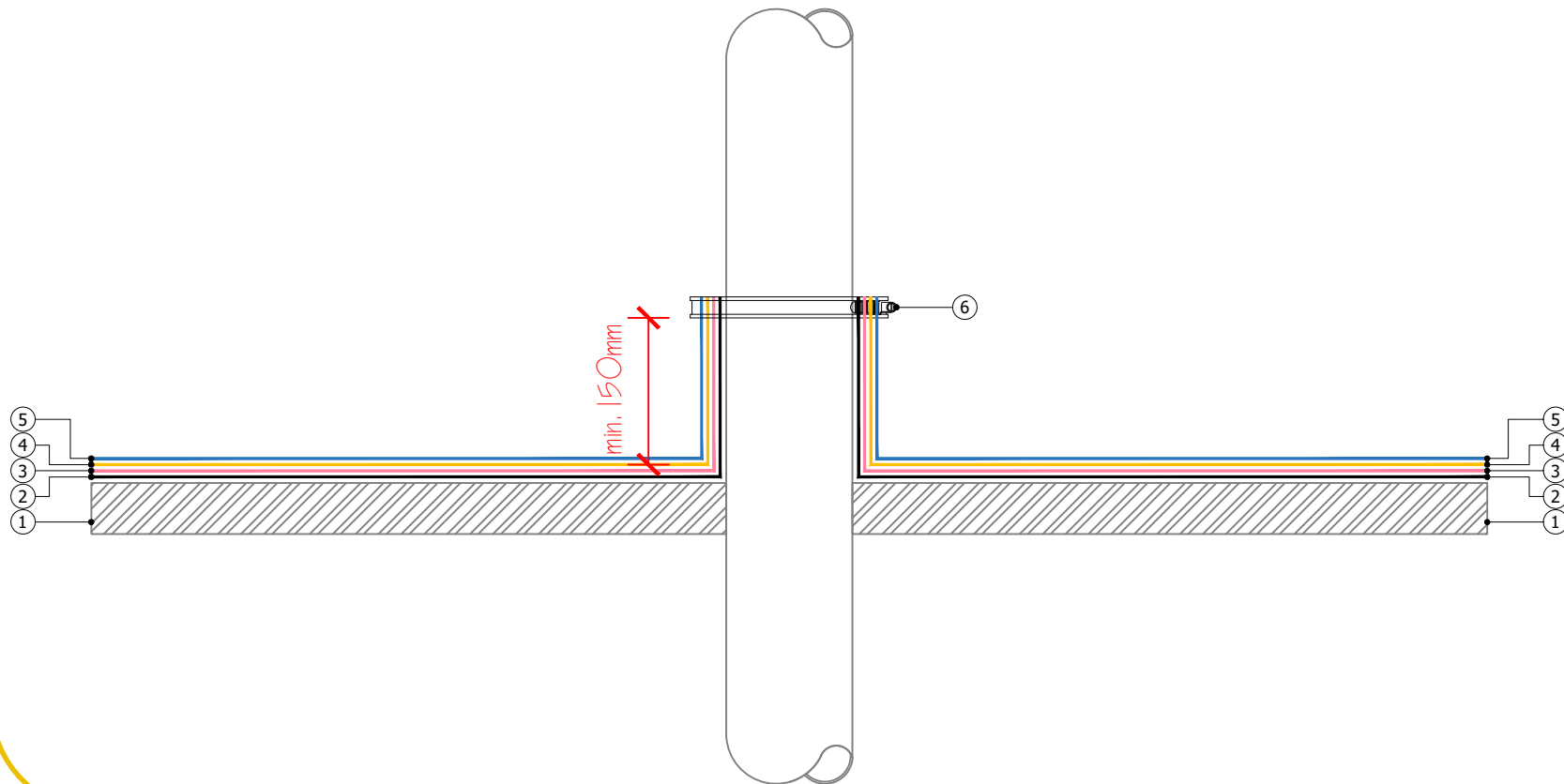

Proteus Waterproofing Ltd.

21a Sirdar Road,
 Brook Road Industrial Estate,
 Rayleigh, Essex, SS6 7XF

Tel: +44 (0)1268 777871

W: www.proteuswaterproofing.co.uk

E: office@proteuswaterproofing.co.uk

All components are to be prepared and installed in strict accordance with Proteus Project Specification

Notes :







This drawing is solely intended to illustrate the correct application of Proteus Waterproofing Ltd's products and systems. All other elements bearing reference to structural and/or thermal design within the detail are shown indicatively and should not be used in whole or part for any aspect of project design without consulting the relevant authorities.

For refurbishment projects, all aspects of the existing roof are deemed to be fully compliant with BS 6229 (Code of practice for flat roofs with continuously supported coverings) or improved upon for instances where these standards are not met.

© This drawing is the copyright of Proteus Waterproofing Ltd.

Drawing No.:		Roof Type:
SD_PC_OVERLAY_10		Overlay
Description:		
Cold Pipe Penetration		
Scale:	Drawn:	Date:
NTS	W.Harding	18/07/2024



- ①  Substrate
- ②  Existing Waterproofing
- ③  Concrete/Timber/Asphalt/Felt Substrate: **Proteus Pro-Vapour Control/Carrier Membrane SA** adhered with **Proteus Pro-Prime® SA**
- ③  PVC Substrate: **Proteus Pro-Vapour Control/Carrier Membrane SA** adhered with **Proteus Pro-Prime® PVC**
- ③  Metal Substrate: **Proteus Pro-Vapour Control/Carrier Membrane SA** adhered with **Proteus Pro-Prime® Epoxy**
- ④  **Proteus Pro-Cold®** base coat with embedded **Proteus Pro-Force 225** reinforcement
- ⑤  **Proteus Pro-Cold®** top coat

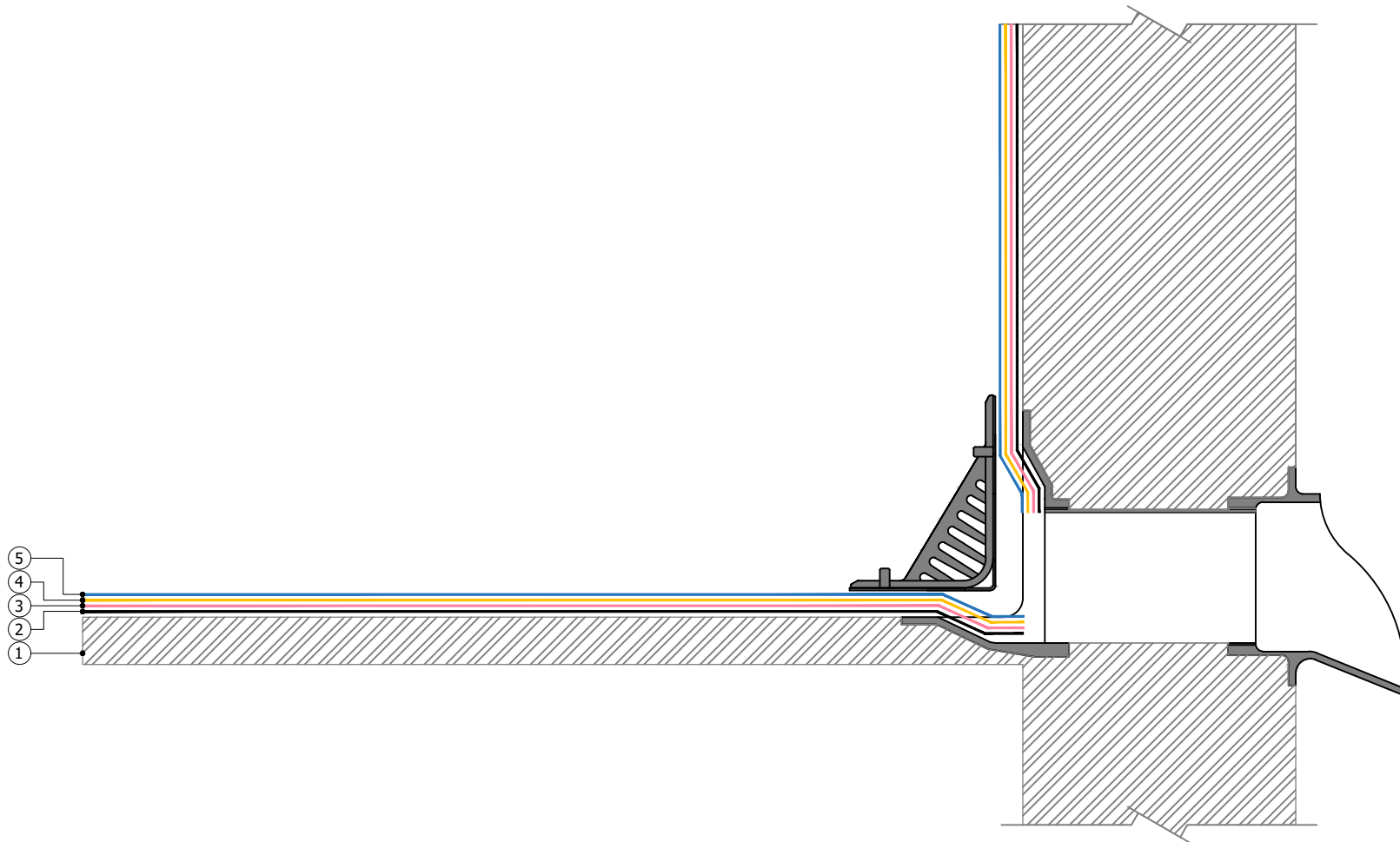

Proteus Waterproofing Ltd.

21a Sirdar Road,
 Brook Road Industrial Estate,
 Rayleigh, Essex, SS6 7XF

Tel: +44 (0)1268 777871

W: www.proteuswaterproofing.co.uk

E: office@proteuswaterproofing.co.uk

All components are to be prepared and installed in strict accordance with Proteus Project Specification

Notes :

This drawing is solely intended to illustrate the correct application of Proteus Waterproofing Ltd's products and systems. All other elements bearing reference to structural and/or thermal design within the detail are shown indicatively and should not be used in whole or part for any aspect of project design without consulting the relevant authorities.

For refurbishment projects, all aspects of the existing roof are deemed to be fully compliant with BS 6229 (Code of practice for flat roofs with continuously supported coverings) or improved upon for instances where these standards are not met.

© This drawing is the copyright of Proteus Waterproofing Ltd.







Drawing No.:	Roof Type:
SD_PC_OVERLAY_12	Overlay

Description:
Parapet Outlet

Scale:	Drawn:	Date:
NTS	W.Harding	18/07/2024

Proteus Pro-Cold®



- ①  Substrate
- ②  Existing Waterproofing
- ③  Concrete/Timber/Asphalt/Felt Substrate: **Proteus Pro-Vapour Control/Carrier Membrane SA** adhered with **Proteus Pro-Prime® SA**
- ③  PVC Substrate: **Proteus Pro-Vapour Control/Carrier Membrane SA** adhered with **Proteus Pro-Prime® PVC**
- ③  Metal Substrate: **Proteus Pro-Vapour Control/Carrier Membrane SA** adhered with **Proteus Pro-Prime® Epoxy**
- ④  **Proteus Pro-Cold®** base coat with embedded **Proteus Pro-Force 225** reinforcement
- ⑤  **Proteus Pro-Cold®** top coat

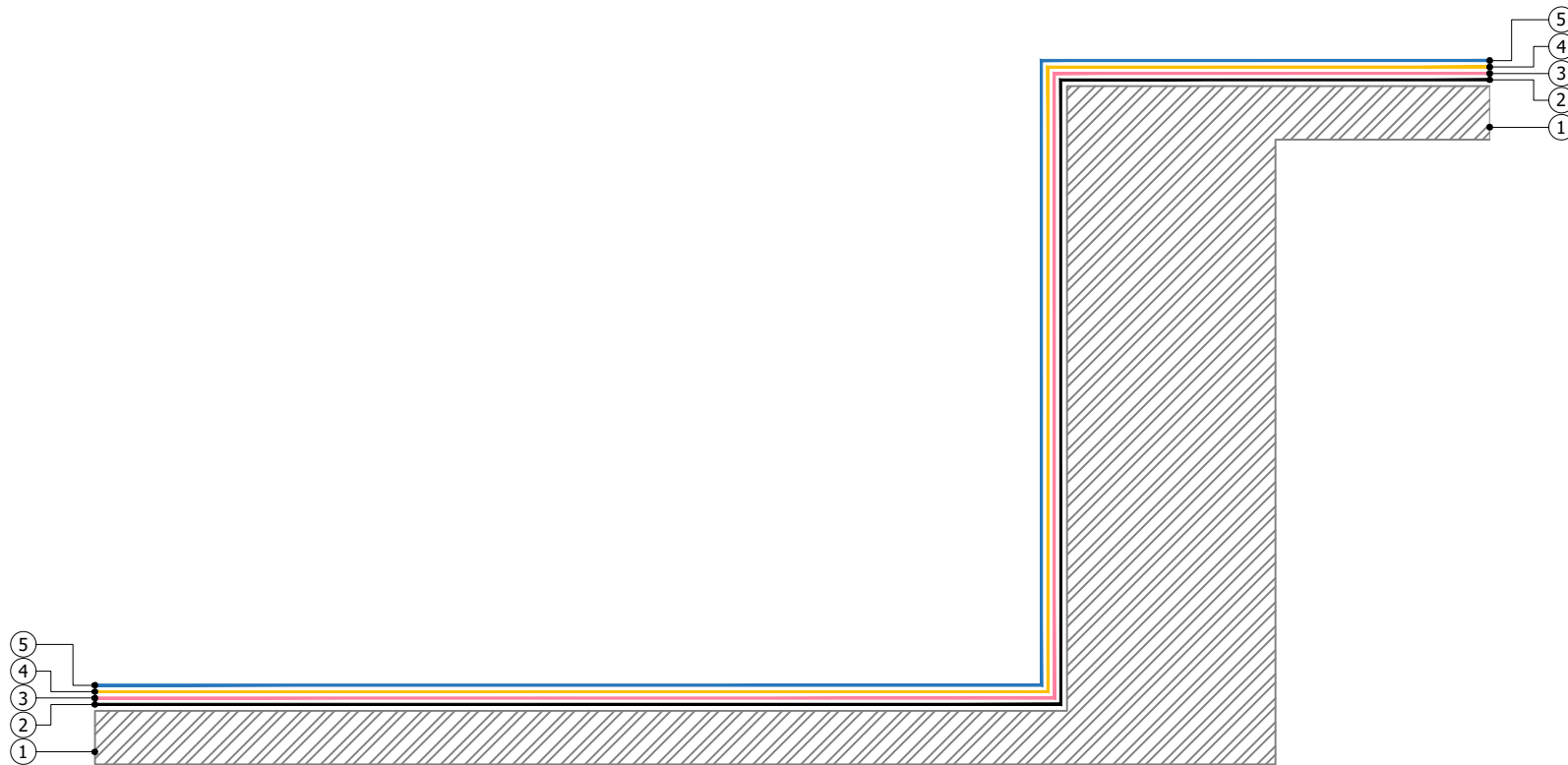

Proteus Waterproofing Ltd.

21a Sirdar Road,
Brook Road Industrial Estate,
Rayleigh, Essex, SS6 7XF

Tel: +44 (0)1268 777871

W: www.proteuswaterproofing.co.uk

E: office@proteuswaterproofing.co.uk

All components are to be prepared and installed in strict accordance with **Proteus Project Specification**

Notes :

This drawing is solely intended to illustrate the correct application of Proteus Waterproofing Ltd's products and systems. All other elements bearing reference to structural and/or thermal design within the detail are shown indicatively and should not be used in whole or part for any aspect of project design without consulting the relevant authorities.

For refurbishment projects, all aspects of the existing roof are deemed to be fully compliant with BS 6229 (Code of practice for flat roofs with continuously supported coverings) or improved upon for instances where these standards are not met.

© This drawing is the copyright of Proteus Waterproofing Ltd.

Drawing No.:	Roof Type:
SD_PC_OVERLAY_13	Overlay

Description:
Roof Transition

Scale:	Drawn:	Date:
NTS	W.Harding	18/07/2024

