







- ①  Substrate
- ②  **Proteus Pro-Vapour Control/Carrier Membrane SA and Proteus Pro-Prime® SA**
- ③  **Proteus Pro-Bond Foaming adhesive**
- ④  **Proteus Pro-Therm Insulation** (tissue faced)
- ⑤  **Proteus Pro-Cold®** base coat with embedded **Proteus Pro-Force 225** reinforcement
- ⑥  **Proteus Pro-Cold®** top coat



**Proteus Waterproofing Ltd.**

21a Sirdar Road,  
Brook Road Industrial Estate,  
Rayleigh, Essex, SS6 7XF

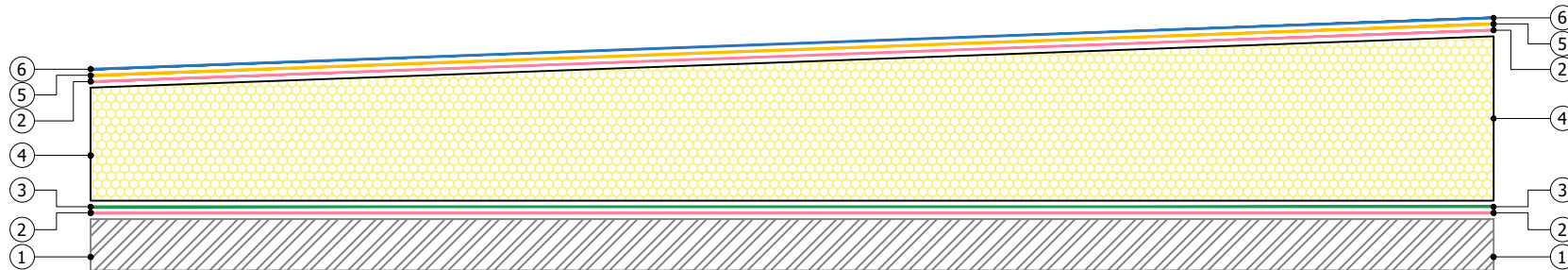
Tel: +44 (0)1268 777871

W: [www.proteuswaterproofing.co.uk](http://www.proteuswaterproofing.co.uk)

E: [office@proteuswaterproofing.co.uk](mailto:office@proteuswaterproofing.co.uk)

**All components are to be prepared and installed in strict accordance with Proteus Project Specification**

**Notes :**

This drawing is solely intended to illustrate the correct application of Proteus Waterproofing Ltd's products and systems. All other elements bearing reference to structural and/or thermal design within the detail are shown indicatively and should not be used in whole or part for any aspect of project design without consulting the relevant authorities.







For refurbishment projects, all aspects of the existing roof are deemed to be fully compliant with BS 6229 (Code of practice for flat roofs with continuously supported coverings) or improved upon for instances where these standards are not met.

© This drawing is the copyright of Proteus Waterproofing Ltd.

Drawing No.: <b>SD_PC_BUR_01</b>		Roof Type: <b>BUR</b>
Description: <b>Horizontal Surface</b>		
Scale: <b>NTS</b>	Drawn: <b>W.Harding</b>	Date: <b>18/07/2024</b>

Proteus Pro-Cold®



- ①  Substrate
- ②  **Proteus Pro-Vapour Control/Carrier Membrane SA and Proteus Pro-Prime® SA**
- ③  **Proteus Pro-Bond Foaming adhesive**
- ④  **Proteus Pro-Therm Insulation** (tissue faced)
- ⑤  **Proteus Pro-Cold®** base coat with embedded **Proteus Pro-Force 225** reinforcement
- ⑥  **Proteus Pro-Cold®** top coat

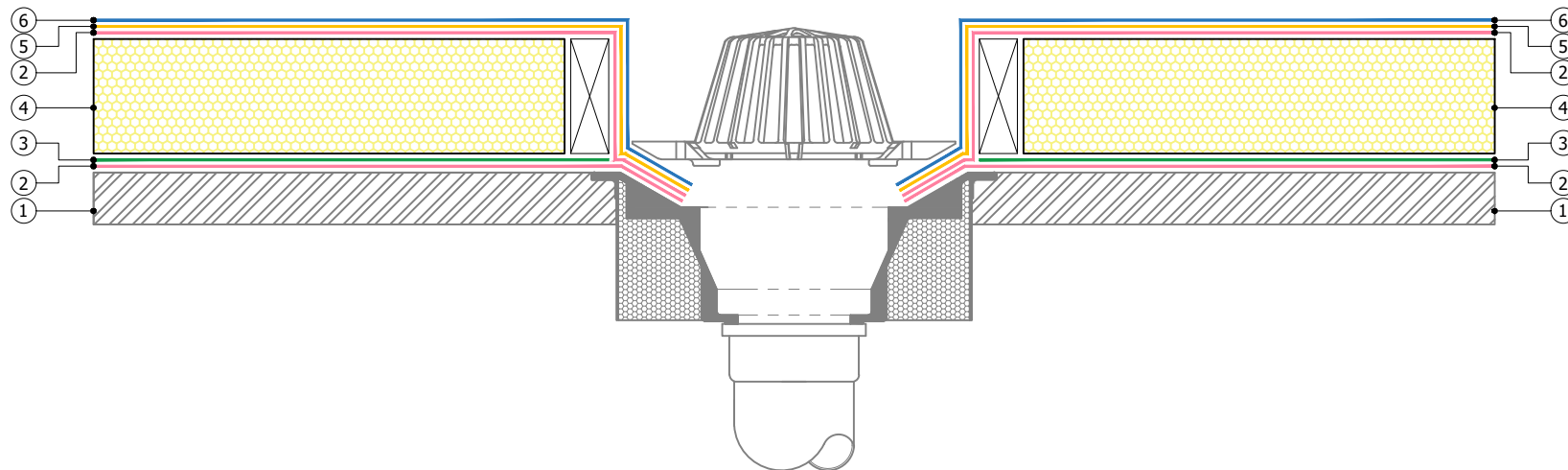

**Proteus Waterproofing Ltd.**

21a Sirdar Road,  
Brook Road Industrial Estate,  
Rayleigh, Essex, SS6 7XF

Tel: +44 (0)1268 777871

W: [www.proteuswaterproofing.co.uk](http://www.proteuswaterproofing.co.uk)

E: [office@proteuswaterproofing.co.uk](mailto:office@proteuswaterproofing.co.uk)

**All components are to be prepared and installed in strict accordance with Proteus Project Specification**

**Notes :**

This drawing is solely intended to illustrate the correct application of Proteus Waterproofing Ltd's products and systems. All other elements bearing reference to structural and/or thermal design within the detail are shown indicatively and should not be used in whole or part for any aspect of project design without consulting the relevant authorities.

For refurbishment projects, all aspects of the existing roof are deemed to be fully compliant with BS 6229 (Code of practice for flat roofs with continuously supported coverings) or improved upon for instances where these standards are not met.

© This drawing is the copyright of Proteus Waterproofing Ltd.









Drawing No.:	Roof Type:
<b>SD_PC_BUR_02</b>	<b>BUR</b>

Description:
<b>Vertical Rainwater Outlet</b>

Scale:	Drawn:	Date:
<b>NTS</b>	<b>W.Harding</b>	<b>18/07/2024</b>

Proteus Pro-Cold®



- ①  Substrate
- ②  Rooflight/ Roof Access Hatch
- ③  **Proteus Pro-Vapour Control/Carrier Membrane SA and Proteus Pro-Prime® SA**
- ④  **Proteus Pro-Bond Foaming adhesive**
- ⑤  **Proteus Pro-Therm Insulation** (tissue faced)
- ⑥  **Proteus Pro-Cold®** base coat with embedded **Proteus Pro-Force 225** reinforcement
- ⑦  **Proteus Pro-Cold®** top coat
- ⑧  **Proteus Sealant**

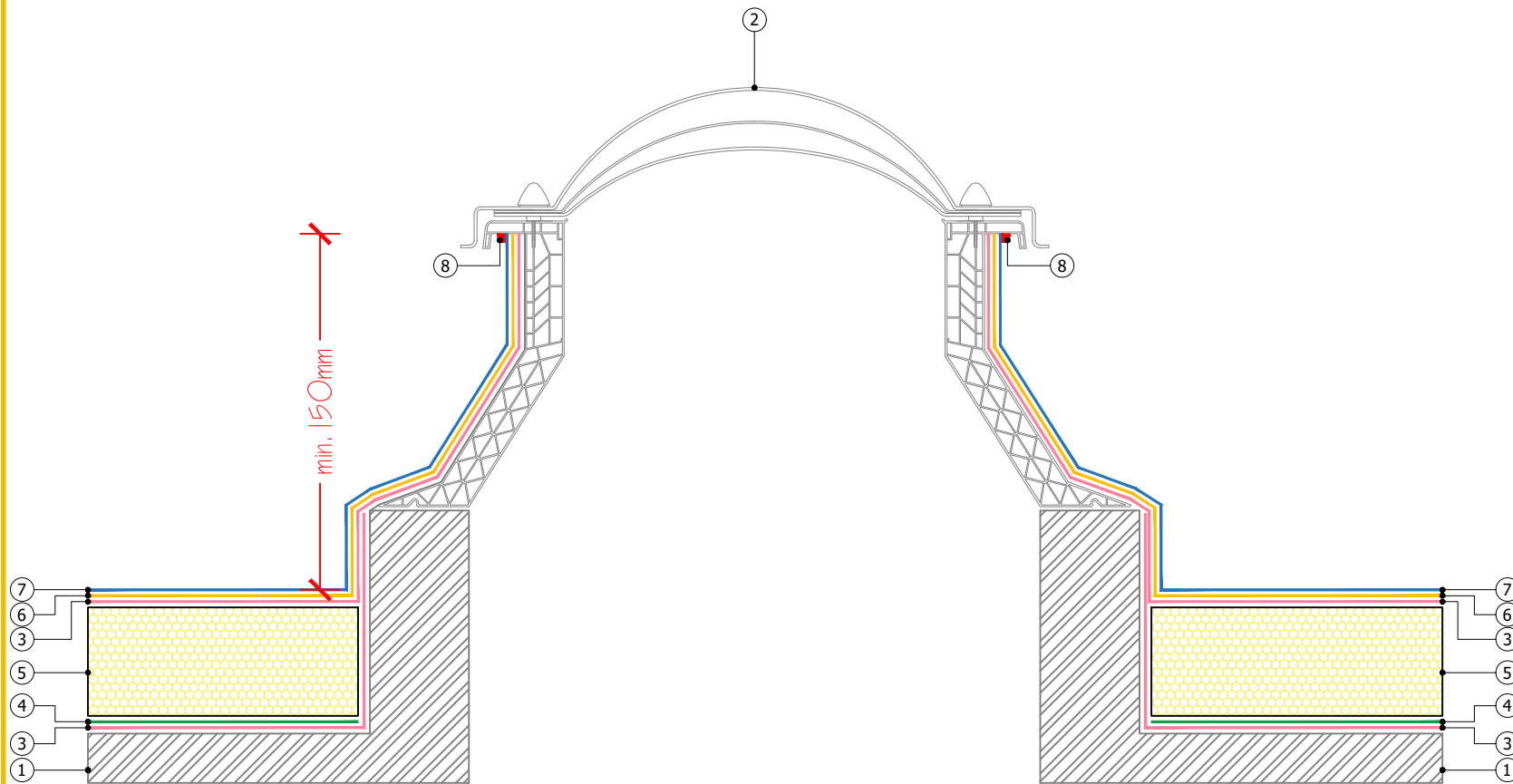

**Proteus Waterproofing Ltd.**

21a Sirdar Road,  
 Brook Road Industrial Estate,  
 Rayleigh, Essex, SS6 7XF

Tel: +44 (0)1268 777871

W: [www.proteuswaterproofing.co.uk](http://www.proteuswaterproofing.co.uk)

E: [office@proteuswaterproofing.co.uk](mailto:office@proteuswaterproofing.co.uk)

**All components are to be prepared and installed in strict accordance with Proteus Project Specification**

**Notes :**

This drawing is solely intended to illustrate the correct application of Proteus Waterproofing Ltd's products and systems. All other elements bearing reference to structural and/or thermal design within the detail are shown indicatively and should not be used in whole or part for any aspect of project design without consulting the relevant authorities.

For refurbishment projects, all aspects of the existing roof are deemed to be fully compliant with BS 6229 (Code of practice for flat roofs with continuously supported coverings) or improved upon for instances where these standards are not met.

© This drawing is the copyright of Proteus Waterproofing Ltd.







Drawing No.:	Roof Type:
<b>SD_PC_BUR_03</b>	<b>BUR</b>

Description:
<b>Rooflight / Access Hatch</b>

Scale:	Drawn:	Date:
<b>NTS</b>	<b>W.Harding</b>	<b>18/07/2024</b>

Proteus Pro-Cold®



- ①  Substrate
- ②  **Proteus Pro-Vapour Control/Carrier Membrane SA and Proteus Pro-Prime<sup>®</sup> SA**
- ③  **Proteus Pro-Bond Foaming adhesive**
- ④  **Proteus Pro-Therm Insulation** (tissue faced)
- ⑤  **Proteus Pro-Cold<sup>®</sup> base coat with embedded Proteus Pro-Force 225 reinforcement**
- ⑥  **Proteus Pro-Cold<sup>®</sup> top coat**
- ⑦  **Proteus Sealant**

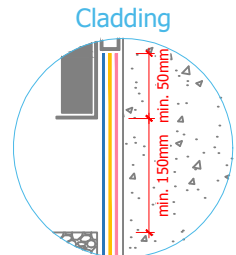

**A** New vertical cladding installed to provide minimum 50mm weathering lap

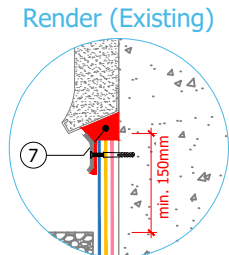

**B** Seal with a continuous minimum 6mm bead of **Proteus Sealant** following through cure of the System

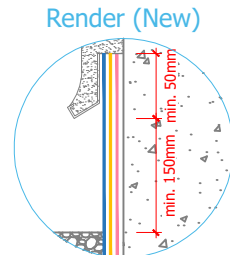

**C** Traditional render application with mechanically fixed bell cast/stop bead installed to overlap Waterproofing membrane by minimum 50mm

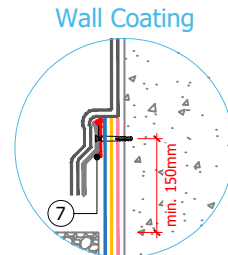

**D** Mechanically fixed **Proteus Counter Flashing** used as the lower termination position of the specified wall coating

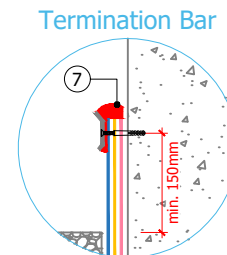

**E** Waterproofing System terminated with a mechanically fixed **Proteus Termination Bar**, sealed and bedded with **Proteus Sealant**

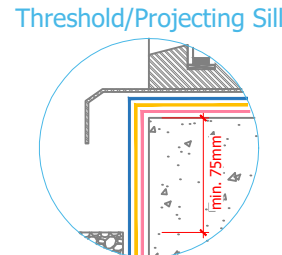

**F** Waterproofing System terminated tightly at the junction with the projecting sill and sealed with **Proteus Sealant**

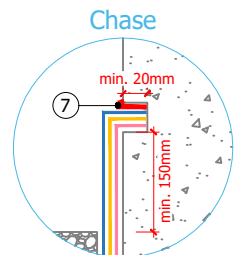

**G** Waterproofing System terminated in a 25mm x 10mm cleaned and primed pre-cut chase sealed with **Proteus Sealant**

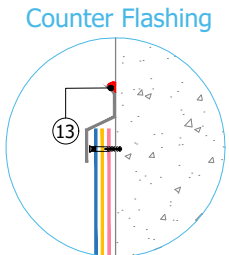

**H** Waterproofing System terminated with a mechanically fixed **Proteus Counter Flashing**, sealed and bedded with **Proteus Sealant**

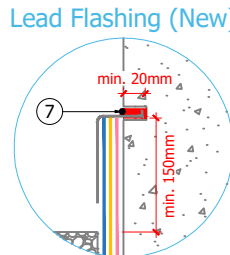

**I** New Lead Flashings installed in strict accordance with BS 6915 and LSA guidelines

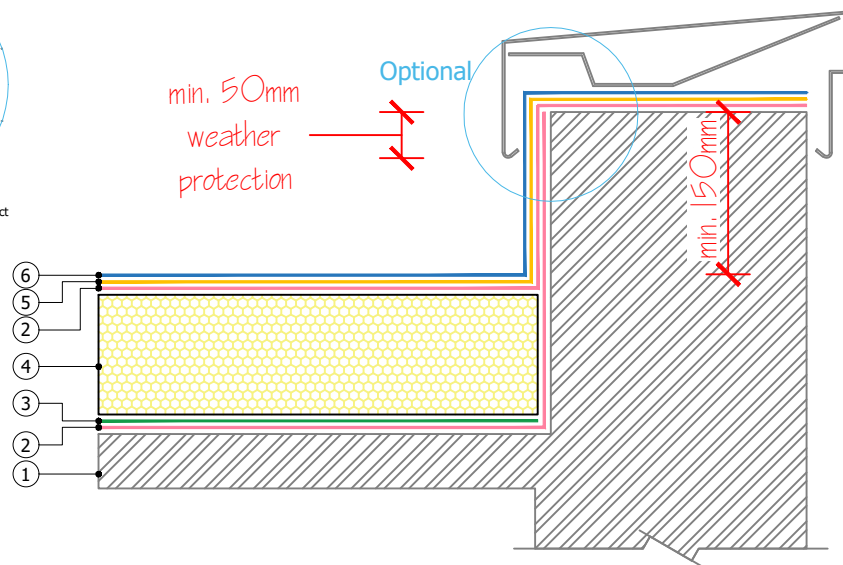

**Proteus Waterproofing Ltd.**

21a Sirdar Road,  
Brook Road Industrial Estate,  
Rayleigh, Essex, SS6 7XF

Tel: +44 (0)1268 777871

W: [www.proteuswaterproofing.co.uk](http://www.proteuswaterproofing.co.uk)

E: [office@proteuswaterproofing.co.uk](mailto:office@proteuswaterproofing.co.uk)

All components are to be prepared and installed in strict accordance with **Proteus Project Specification**

**Notes :**

This drawing is solely intended to illustrate the correct application of Proteus Waterproofing Ltd's products and systems. All other elements bearing reference to structural and/or thermal design within the detail are shown indicatively and should not be used in whole or part for any aspect of project design without consulting the relevant authorities.







For refurbishment projects, all aspects of the existing roof are deemed to be fully compliant with BS 6229 (Code of practice for flat roofs with continuously supported coverings) or improved upon for instances where these standards are not met.

© This drawing is the copyright of Proteus Waterproofing Ltd.

Drawing No.: <b>SD_PC_BUR_04</b>		Roof Type: <b>BUR</b>
Description: <b>Upstand Terminations</b>		
Scale: <b>NTS</b>	Drawn: <b>W.Harding</b>	Date: <b>17/09/2024</b>

Proteus Pro-Cold<sup>®</sup>



- ①  Substrate
- ②  **Proteus Pro-Vapour Control/Carrier Membrane SA and Proteus Pro-Prime® SA**
- ③  **Proteus Pro-Bond Foaming adhesive**
- ④  **Proteus Pro-Therm Insulation** (tissue faced)
- ⑤  **Proteus Pro-Cold®** base coat with embedded **Proteus Pro-Force 225** reinforcement
- ⑥  **Proteus Pro-Cold®** top coat

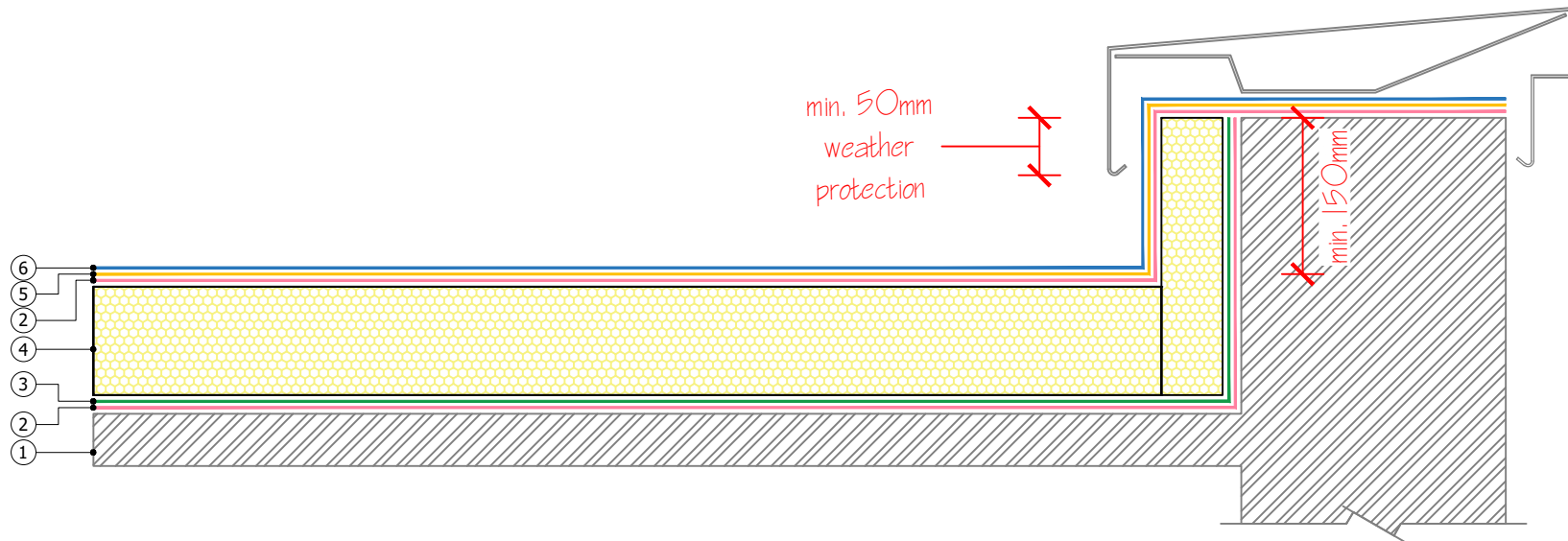

**Proteus Waterproofing Ltd.**

21a Sirdar Road,  
Brook Road Industrial Estate,  
Rayleigh, Essex, SS6 7XF

Tel: +44 (0)1268 777871

W: [www.proteuswaterproofing.co.uk](http://www.proteuswaterproofing.co.uk)

E: [office@proteuswaterproofing.co.uk](mailto:office@proteuswaterproofing.co.uk)

**All components are to be prepared and installed in strict accordance with Proteus Project Specification**

**Notes :**







This drawing is solely intended to illustrate the correct application of Proteus Waterproofing Ltd's products and systems. All other elements bearing reference to structural and/or thermal design within the detail are shown indicatively and should not be used in whole or part for any aspect of project design without consulting the relevant authorities.

For refurbishment projects, all aspects of the existing roof are deemed to be fully compliant with BS 6229 (Code of practice for flat roofs with continuously supported coverings) or improved upon for instances where these standards are not met.

© This drawing is the copyright of Proteus Waterproofing Ltd.

Drawing No.:		Roof Type:
<b>SD_PC_BUR_05</b>		<b>BUR</b>
Description:		
<b>Insulated Parapet - Capping</b>		
Scale:	Drawn:	Date:
<b>NTS</b>	<b>W.Harding</b>	<b>18/07/2024</b>



- ①  Substrate
- ②  **Proteus Pro-Vapour Control/Carrier Membrane SA and Proteus Pro-Prime® SA**
- ③  **Proteus Pro-Bond Foaming adhesive**
- ④  **Proteus Pro-Therm Insulation** (tissue faced)
- ⑤  **Proteus Pro-Cold®** base coat with embedded **Proteus Pro-Force 225** reinforcement
- ⑥  **Proteus Pro-Cold®** top coat

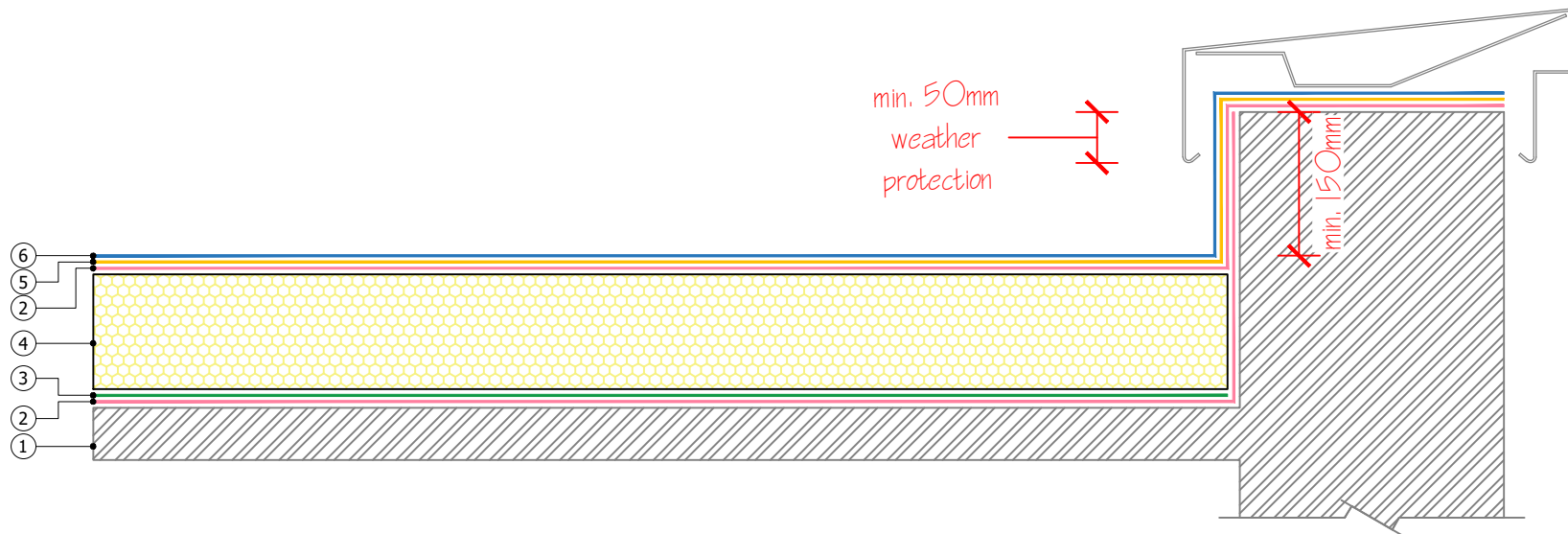

**Proteus Waterproofing Ltd.**

21a Sirdar Road,  
Brook Road Industrial Estate,  
Rayleigh, Essex, SS6 7XF

Tel: +44 (0)1268 777871

W: [www.proteuswaterproofing.co.uk](http://www.proteuswaterproofing.co.uk)

E: [office@proteuswaterproofing.co.uk](mailto:office@proteuswaterproofing.co.uk)

**All components are to be prepared and installed in strict accordance with Proteus Project Specification**

**Notes :**







This drawing is solely intended to illustrate the correct application of Proteus Waterproofing Ltd's products and systems. All other elements bearing reference to structural and/or thermal design within the detail are shown indicatively and should not be used in whole or part for any aspect of project design without consulting the relevant authorities.

For refurbishment projects, all aspects of the existing roof are deemed to be fully compliant with BS 6229 (Code of practice for flat roofs with continuously supported coverings) or improved upon for instances where these standards are not met.

© This drawing is the copyright of Proteus Waterproofing Ltd.

Drawing No.:		Roof Type:
<b>SD_PC_BUR_06</b>		<b>BUR</b>
Description:		
<b>Uninsulated Parapet - Capping</b>		
Scale:	Drawn:	Date:
<b>NTS</b>	<b>W.Harding</b>	<b>18/07/2024</b>



- ①  Substrate
- ②  **GRP Trim** (mechanically fixed) and **Proteus Sealant**
- ③  **Proteus Pro-Vapour Control/Carrier Membrane SA** and **Proteus Pro-Prime® SA**
- ④  **Proteus Pro-Bond Foaming** adhesive
- ⑤  **Proteus Pro-Therm Insulation** (tissue faced)
- ⑥  **Proteus Pro-Cold®** base coat with embedded **Proteus Pro-Force 225** reinforcement
- ⑦  **Proteus Pro-Cold®** top coat

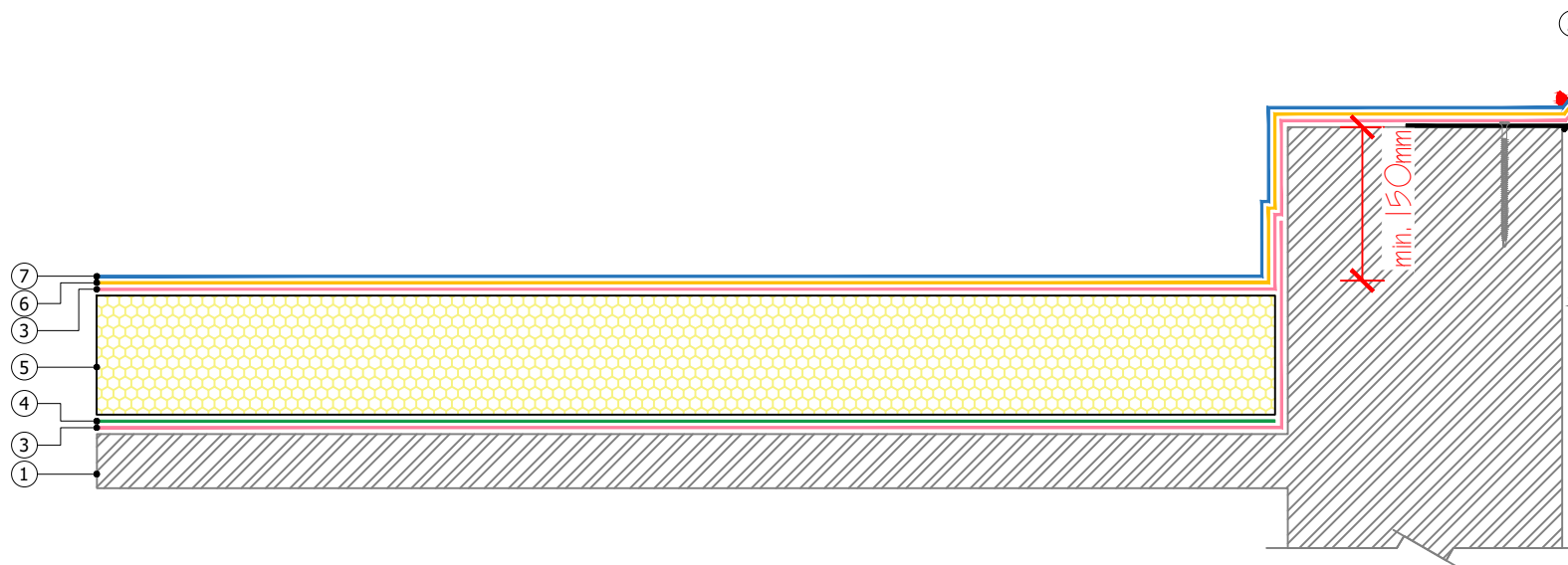

### Proteus Waterproofing Ltd.

21a Sirdar Road,  
Brook Road Industrial Estate,  
Rayleigh, Essex, SS6 7XF

Tel: +44 (0)1268 777871

W: [www.proteuswaterproofing.co.uk](http://www.proteuswaterproofing.co.uk)

E: [office@proteuswaterproofing.co.uk](mailto:office@proteuswaterproofing.co.uk)

All components are to be prepared and installed in strict accordance with **Proteus Project Specification**

#### Notes :

This drawing is solely intended to illustrate the correct application of Proteus Waterproofing Ltd's products and systems. All other elements bearing reference to structural and/or thermal design within the detail are shown indicatively and should not be used in whole or part for any aspect of project design without consulting the relevant authorities.







For refurbishment projects, all aspects of the existing roof are deemed to be fully compliant with BS 6229 (Code of practice for flat roofs with continuously supported coverings) or improved upon for instances where these standards are not met.

© This drawing is the copyright of Proteus Waterproofing Ltd.

Drawing No.:		Roof Type:
<b>SD_PC_BUR_07</b>		<b>BUR</b>
Description:		
<b>Parapet - GRP Trim</b>		
Scale:	Drawn:	Date:
<b>NTS</b>	<b>W.Harding</b>	<b>18/07/2024</b>





- ①  Substrate
- ②  **Proteus Pro-Vapour Control/Carrier Membrane SA and Proteus Pro-Prime® SA**
- ③  **Proteus Pro-Bond Foaming adhesive**
- ④  **Proteus Pro-Therm Insulation** (tissue faced)
- ⑤  **Proteus Pro-Cold®** base coat with embedded **Proteus Pro-Force 225** reinforcement
- ⑥  **Proteus Pro-Cold®** top coat
- ⑦  **Proteus Sealant**

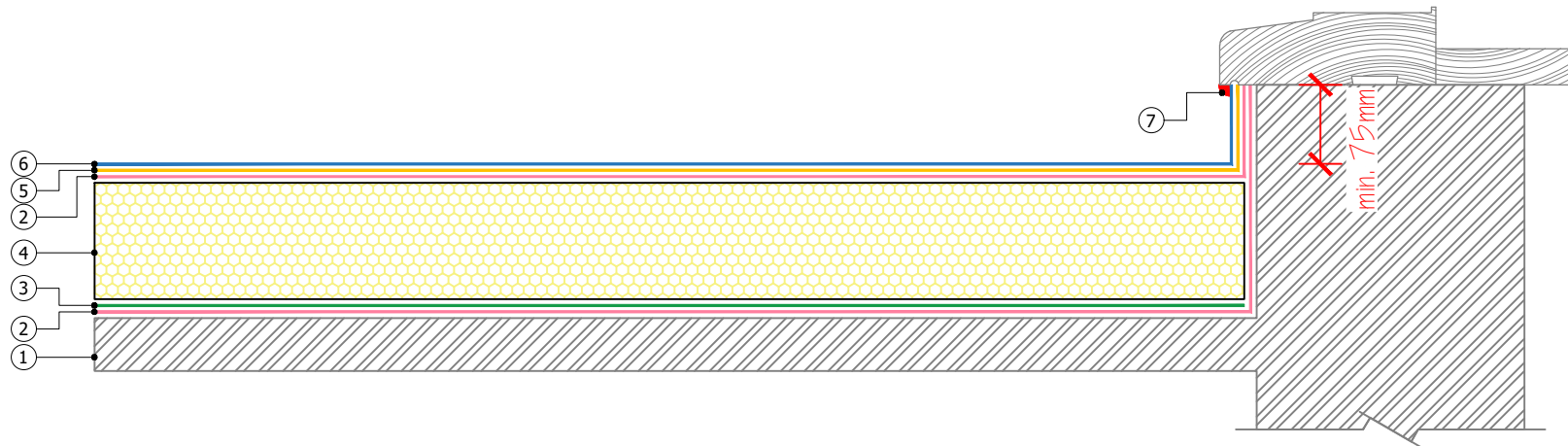

**Proteus Waterproofing Ltd.**

21a Sirdar Road,  
Brook Road Industrial Estate,  
Rayleigh, Essex, SS6 7XF

Tel: +44 (0)1268 777871

W: [www.proteuswaterproofing.co.uk](http://www.proteuswaterproofing.co.uk)

E: [office@proteuswaterproofing.co.uk](mailto:office@proteuswaterproofing.co.uk)

**All components are to be prepared and installed in strict accordance with Proteus Project Specification**

**Notes :**

This drawing is solely intended to illustrate the correct application of Proteus Waterproofing Ltd's products and systems. All other elements bearing reference to structural and/or thermal design within the detail are shown indicatively and should not be used in whole or part for any aspect of project design without consulting the relevant authorities.







For refurbishment projects, all aspects of the existing roof are deemed to be fully compliant with BS 6229 (Code of practice for flat roofs with continuously supported coverings) or improved upon for instances where these standards are not met.

© This drawing is the copyright of Proteus Waterproofing Ltd.

Drawing No.:		Roof Type:
<b>SD_PC_BUR_08</b>		<b>BUR</b>
Description:		
<b>Threshold (Existing) - Sealant</b>		
Scale:	Drawn:	Date:
<b>NTS</b>	<b>W.Harding</b>	<b>18/07/2024</b>





- ①  Substrate
- ②  **Proteus Pro-Vapour Control/Carrier Membrane SA and Proteus Pro-Prime® SA**
- ③  **Proteus Pro-Bond Foaming adhesive**
- ④  **Proteus Pro-Therm Insulation** (tissue faced)
- ⑤  **Proteus Pro-Cold®** base coat with embedded **Proteus Pro-Force 225** reinforcement
- ⑥  **Proteus Pro-Cold®** top coat
- ⑦  EPDM membrane (min. 100mm lap onto waterproofing)

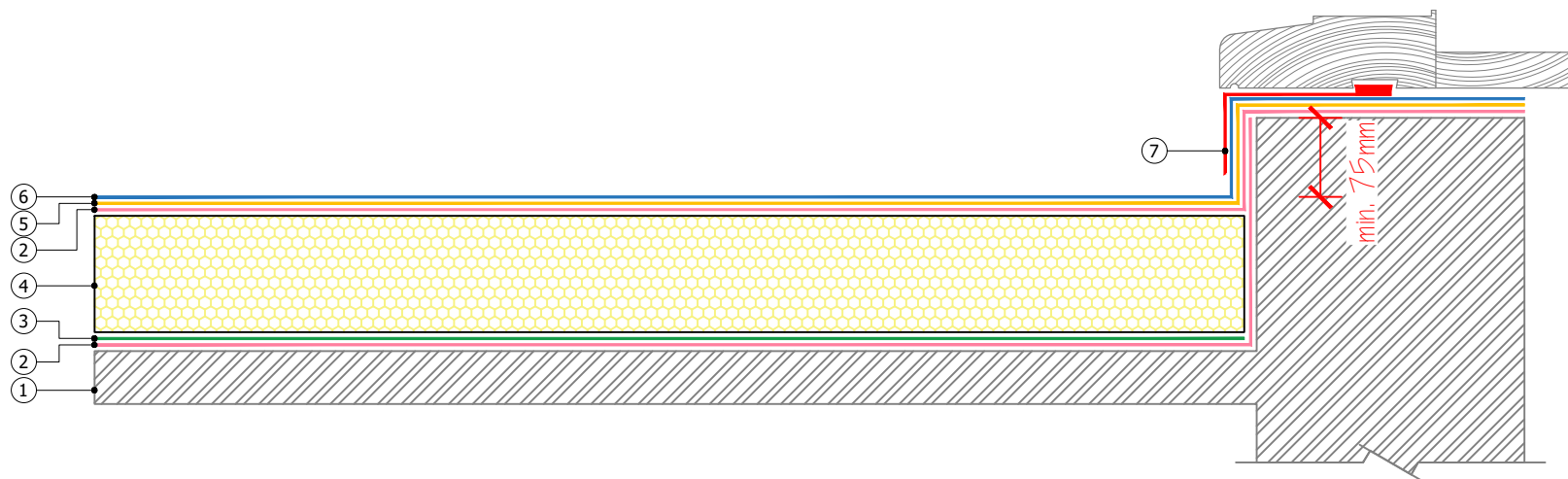

**Proteus Waterproofing Ltd.**

21a Sirdar Road,  
Brook Road Industrial Estate,  
Rayleigh, Essex, SS6 7XF

Tel: +44 (0)1268 777871

W: [www.proteuswaterproofing.co.uk](http://www.proteuswaterproofing.co.uk)

E: [office@proteuswaterproofing.co.uk](mailto:office@proteuswaterproofing.co.uk)

**All components are to be prepared and installed in strict accordance with Proteus Project Specification**

**Notes :**







This drawing is solely intended to illustrate the correct application of Proteus Waterproofing Ltd's products and systems. All other elements bearing reference to structural and/or thermal design within the detail are shown indicatively and should not be used in whole or part for any aspect of project design without consulting the relevant authorities.

For refurbishment projects, all aspects of the existing roof are deemed to be fully compliant with BS 6229 (Code of practice for flat roofs with continuously supported coverings) or improved upon for instances where these standards are not met.

© This drawing is the copyright of Proteus Waterproofing Ltd.

Drawing No.:		Roof Type:
<b>SD_PC_BUR_09</b>		<b>BUR</b>
Description:		
<b>Threshold (New) - EPDM</b>		
Scale:	Drawn:	Date:
<b>NTS</b>	<b>W.Harding</b>	<b>18/07/2024</b>



- ①  Substrate
- ②  **Proteus Pro-Vapour Control/Carrier Membrane SA and Proteus Pro-Prime<sup>®</sup> SA**
- ③  **Proteus Pro-Bond Foaming adhesive**
- ④  **Proteus Pro-Therm Insulation** (tissue faced)
- ⑤  **Proteus Pro-Cold<sup>®</sup> base coat with embedded Proteus Pro-Force 225 reinforcement**
- ⑥  **Proteus Pro-Cold<sup>®</sup> top coat**
- ⑦  Jubilee Clip

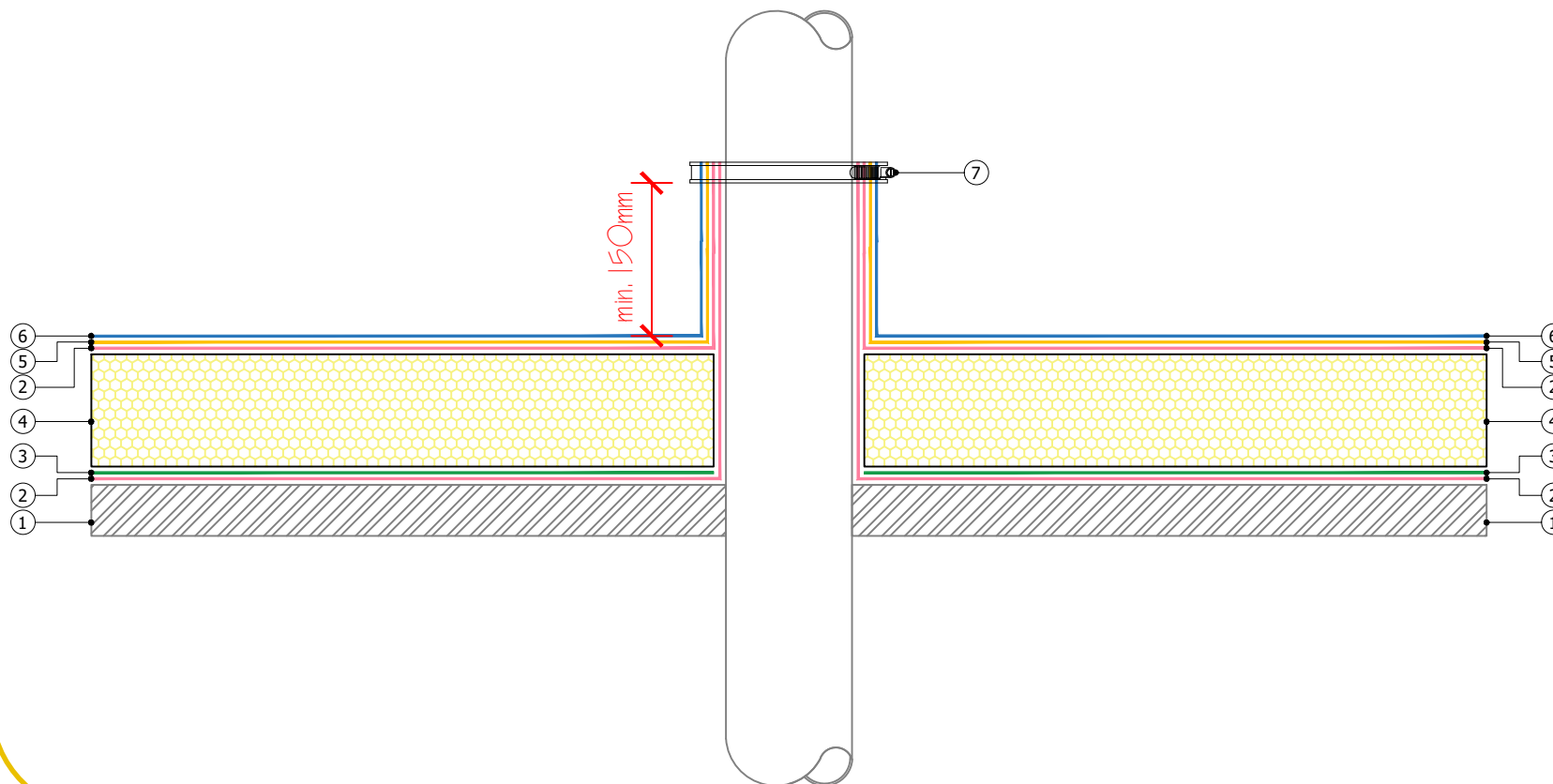

**Proteus Waterproofing Ltd.**

21a Sirdar Road,  
Brook Road Industrial Estate,  
Rayleigh, Essex, SS6 7XF

Tel: +44 (0)1268 777871

W: [www.proteuswaterproofing.co.uk](http://www.proteuswaterproofing.co.uk)

E: [office@proteuswaterproofing.co.uk](mailto:office@proteuswaterproofing.co.uk)

**All components are to be prepared and installed in strict accordance with Proteus Project Specification**

**Notes :**







This drawing is solely intended to illustrate the correct application of Proteus Waterproofing Ltd's products and systems. All other elements bearing reference to structural and/or thermal design within the detail are shown indicatively and should not be used in whole or part for any aspect of project design without consulting the relevant authorities.

For refurbishment projects, all aspects of the existing roof are deemed to be fully compliant with BS 6229 (Code of practice for flat roofs with continuously supported coverings) or improved upon for instances where these standards are not met.

© This drawing is the copyright of Proteus Waterproofing Ltd.

Drawing No.:		Roof Type:
<b>SD_PC_BUR_10</b>		<b>BUR</b>
Description:		
<b>Cold Pipe Penetration</b>		
Scale:	Drawn:	Date:
<b>NTS</b>	<b>W.Harding</b>	<b>18/07/2024</b>



- ①  Substrate
- ②  **Proteus Pro-Vapour Control/Carrier Membrane SA and Proteus Pro-Prime® SA**
- ③  **Proteus Pro-Bond Foaming adhesive**
- ④  **Proteus Pro-Therm Insulation** (tissue faced)
- ⑤  **Proteus Pro-Cold®** base coat with embedded **Proteus Pro-Force 225** reinforcement
- ⑥  **Proteus Pro-Cold®** top coat

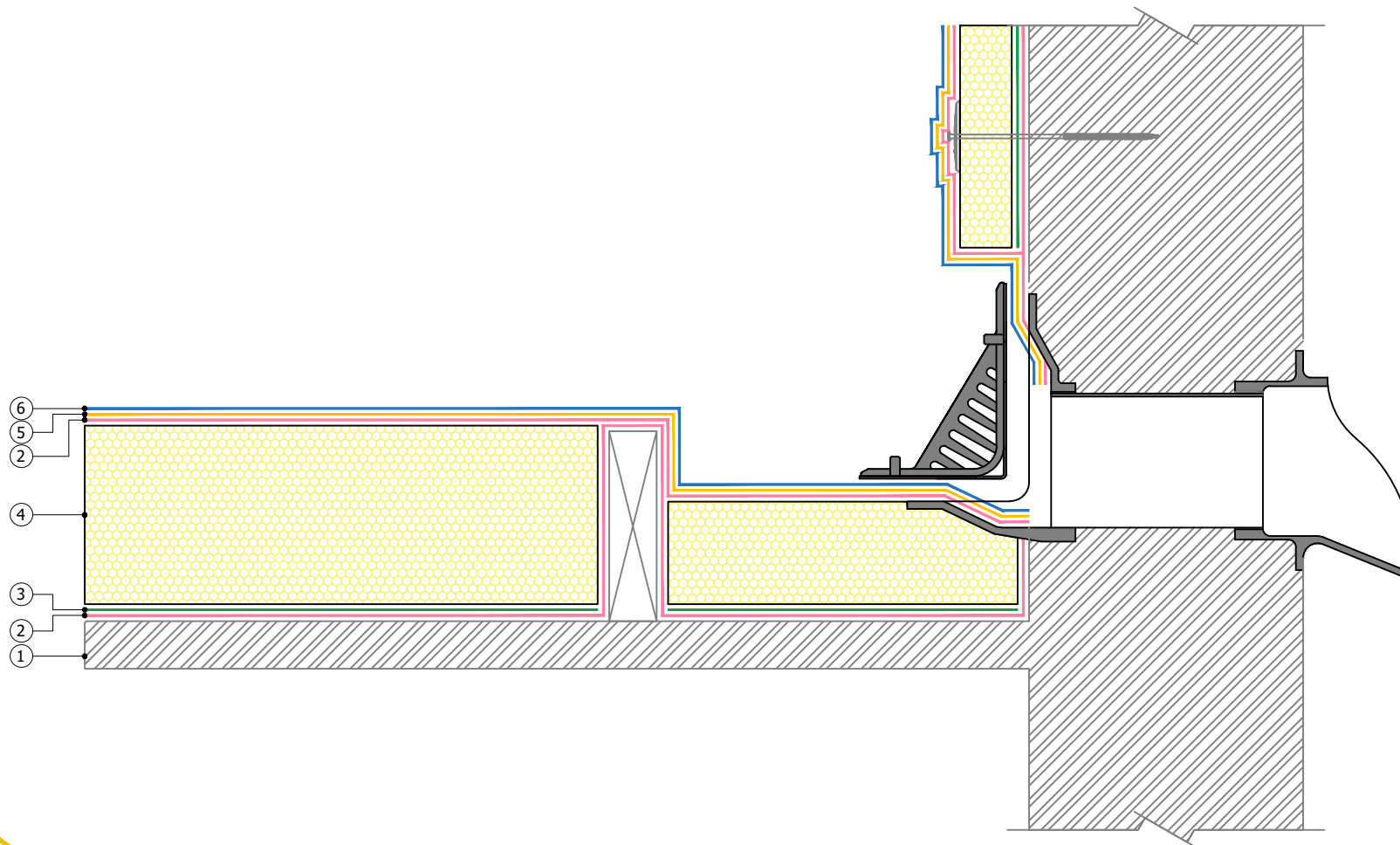

**Proteus Waterproofing Ltd.**

21a Sirdar Road,  
Brook Road Industrial Estate,  
Rayleigh, Essex, SS6 7XF

Tel: +44 (0)1268 777871

W: [www.proteuswaterproofing.co.uk](http://www.proteuswaterproofing.co.uk)

E: [office@proteuswaterproofing.co.uk](mailto:office@proteuswaterproofing.co.uk)

**All components are to be prepared and installed in strict accordance with Proteus Project Specification**

**Notes :**

This drawing is solely intended to illustrate the correct application of Proteus Waterproofing Ltd's products and systems. All other elements bearing reference to structural and/or thermal design within the detail are shown indicatively and should not be used in whole or part for any aspect of project design without consulting the relevant authorities.







For refurbishment projects, all aspects of the existing roof are deemed to be fully compliant with BS 6229 (Code of practice for flat roofs with continuously supported coverings) or improved upon for instances where these standards are not met.

© This drawing is the copyright of Proteus Waterproofing Ltd.

Drawing No.:		Roof Type:
<b>SD_PC_BUR_11</b>		<b>BUR</b>
Description:		
<b>Insulated Parapet Gutter</b>		
Scale:	Drawn:	Date:
<b>NTS</b>	<b>W.Harding</b>	<b>18/07/2024</b>

Proteus Pro-Cold®



- ①  Substrate
- ②  **Proteus Pro-Vapour Control/Carrier Membrane SA and Proteus Pro-Prime® SA**
- ③  **Proteus Pro-Bond Foaming adhesive**
- ④  **Proteus Pro-Therm Insulation** (tissue faced)
- ⑤  **Proteus Pro-Cold®** base coat with embedded **Proteus Pro-Force 225** reinforcement
- ⑥  **Proteus Pro-Cold®** top coat

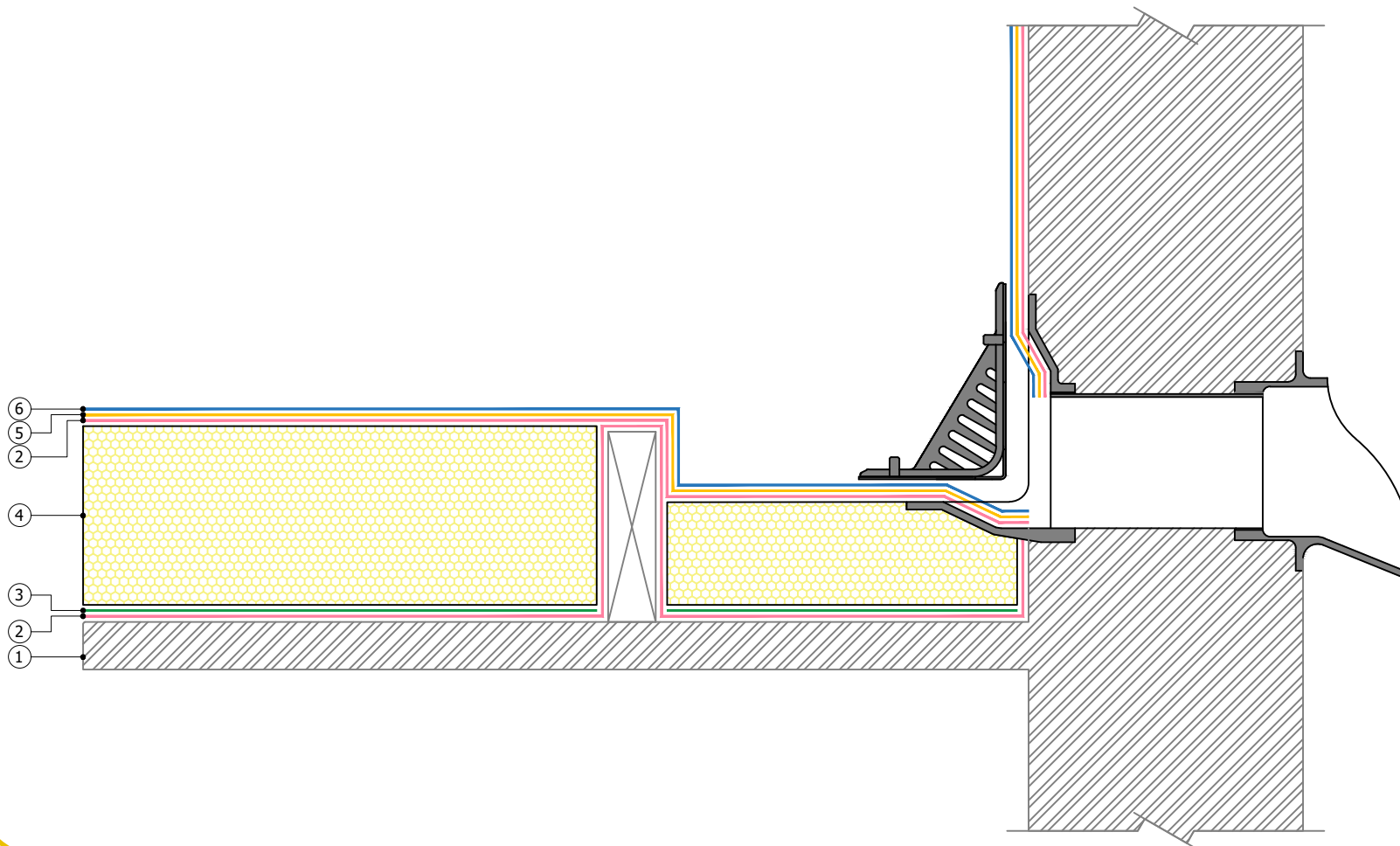

**Proteus Waterproofing Ltd.**

21a Sirdar Road,  
Brook Road Industrial Estate,  
Rayleigh, Essex, SS6 7XF

Tel: +44 (0)1268 777871

W: [www.proteuswaterproofing.co.uk](http://www.proteuswaterproofing.co.uk)

E: [office@proteuswaterproofing.co.uk](mailto:office@proteuswaterproofing.co.uk)

**All components are to be prepared and installed in strict accordance with Proteus Project Specification**

**Notes :**







This drawing is solely intended to illustrate the correct application of Proteus Waterproofing Ltd's products and systems. All other elements bearing reference to structural and/or thermal design within the detail are shown indicatively and should not be used in whole or part for any aspect of project design without consulting the relevant authorities.

For refurbishment projects, all aspects of the existing roof are deemed to be fully compliant with BS 6229 (Code of practice for flat roofs with continuously supported coverings) or improved upon for instances where these standards are not met.

© This drawing is the copyright of Proteus Waterproofing Ltd.

Drawing No.:		Roof Type:
<b>SD_PC_BUR_12</b>		<b>BUR</b>
Description:		
<b>Uninsulated Parapet Gutter</b>		
Scale:	Drawn:	Date:
<b>NTS</b>	<b>W.Harding</b>	<b>18/07/2024</b>



- ①  Substrate
- ②  **Proteus Pro-Vapour Control/Carrier Membrane SA and Proteus Pro-Prime® SA**
- ③  **Proteus Pro-Bond Foaming adhesive**
- ④  **Proteus Pro-Therm Insulation** (tissue faced)
- ⑤  Metal angle
- ⑥  **Proteus Pro-Cold®** base coat with embedded **Proteus Pro-Force 225** reinforcement
- ⑦  **Proteus Pro-Cold®** top coat

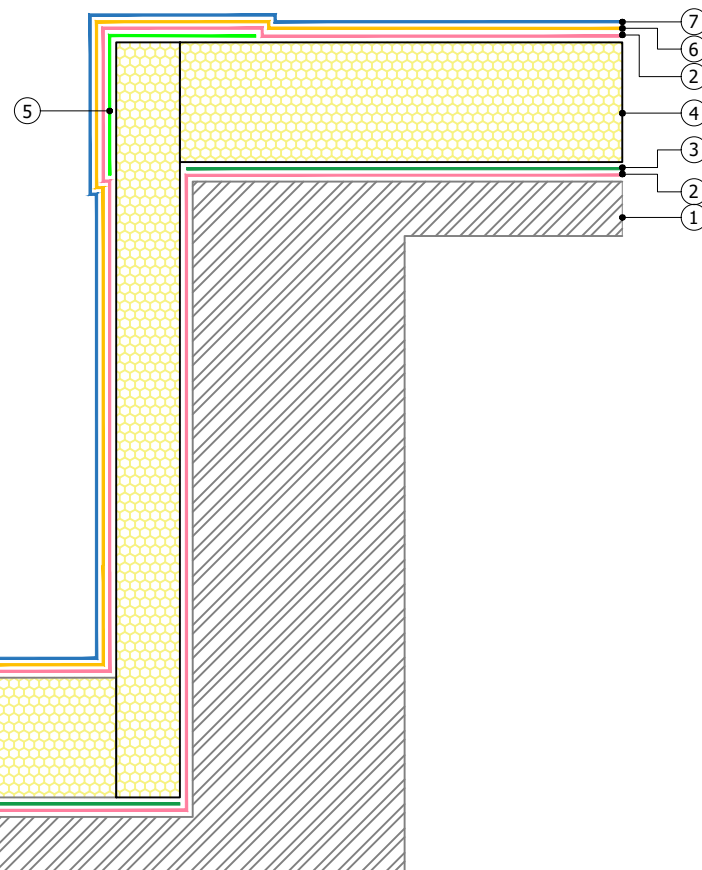

**Proteus Waterproofing Ltd.**

21a Sirdar Road,  
Brook Road Industrial Estate,  
Rayleigh, Essex, SS6 7XF

Tel: +44 (0)1268 777871

W: [www.proteuswaterproofing.co.uk](http://www.proteuswaterproofing.co.uk)

E: [office@proteuswaterproofing.co.uk](mailto:office@proteuswaterproofing.co.uk)

**All components are to be prepared and installed in strict accordance with Proteus Project Specification**

**Notes :**

This drawing is solely intended to illustrate the correct application of Proteus Waterproofing Ltd's products and systems. All other elements bearing reference to structural and/or thermal design within the detail are shown indicatively and should not be used in whole or part for any aspect of project design without consulting the relevant authorities.

For refurbishment projects, all aspects of the existing roof are deemed to be fully compliant with BS 6229 (Code of practice for flat roofs with continuously supported coverings) or improved upon for instances where these standards are not met.

© This drawing is the copyright of Proteus Waterproofing Ltd.

Drawing No.:		Roof Type:
<b>SD_PC_BUR_13</b>		<b>BUR</b>
Description:		
<b>Roof Transition</b>		
Scale:	Drawn:	Date:
<b>NTS</b>	<b>W.Harding</b>	<b>18/07/2024</b>

